

# Cunningham Court, Oliver Road, E10 5LE

Approx. Gross Internal Area 875 Sq Ft - 81.29 Sq M

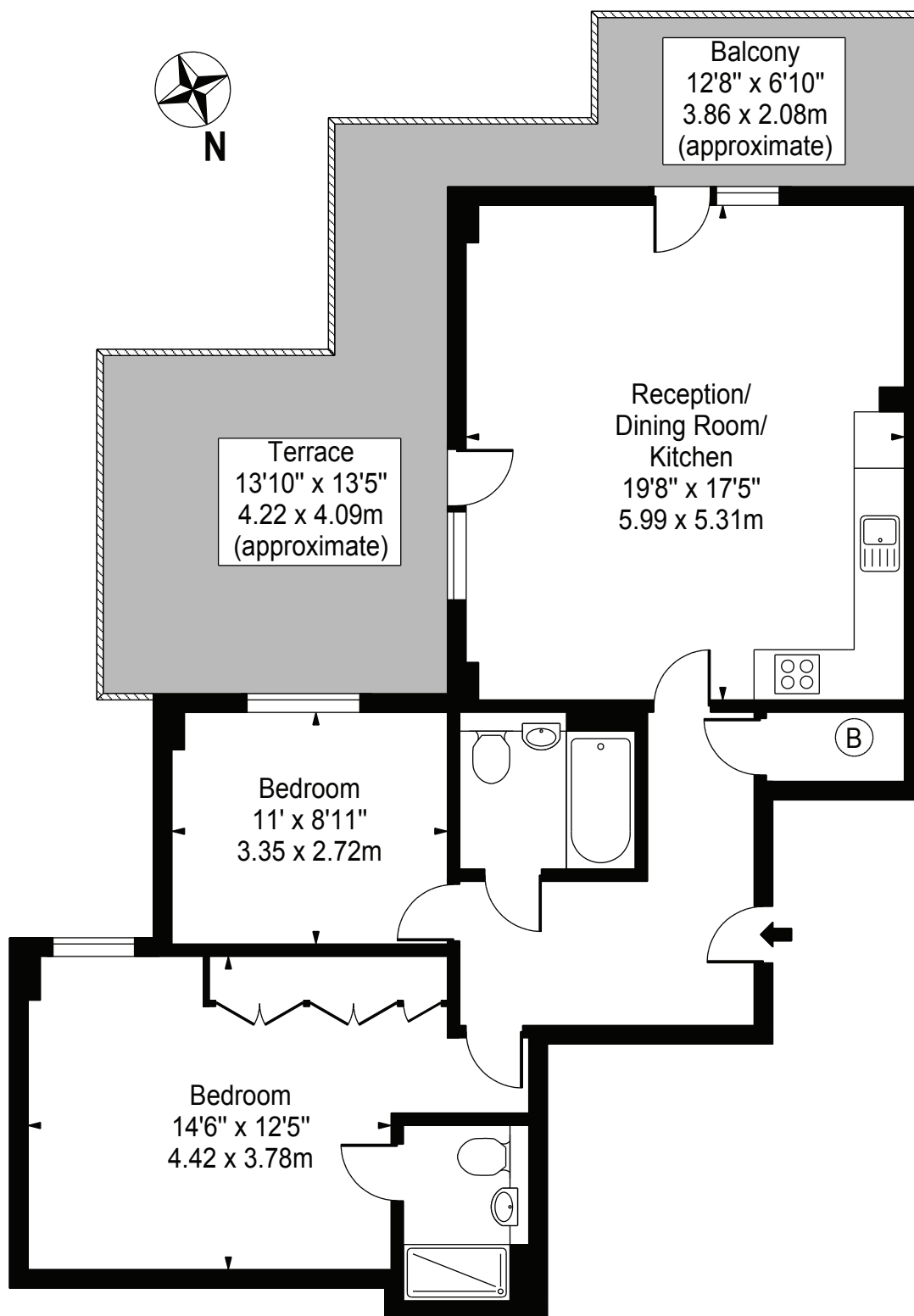

Fifth Floor

For Illustration Purposes Only - Not To Scale - Floor Plan by interDesign Photography  
[www.interdesignphotography.com](http://www.interdesignphotography.com)

This floor plan should be used as general outline for guidance only.  
All measurements are approximate and for illustration purposes only as defined by the RICS Code of Measuring Practice ©2016.