



King`s Road, Chelsea SW3

ASHDOWN MARKS  
PROPERTY CONSULTANTS

# King`s Road, Chelsea SW3

A recently refurbished one bedroom apartment located a short walk from Sloane Square with views over Duke of York Square with fantastic storage and access to communal gardens by separate arrangement.

- 1 Bedroom
- 1 Bathroom
- Reception Room
- Separate Kitchen
- Unfurnished
- Access to communal gardens by separate arrangement
- Close to Underground
- Wonderful Views
- EPC - Rating C
- Council Tax - Band E

To Let

Price £725 pw







## Kings Road, London, SW3

Approximate Gross Internal Area

**52.63 sq m / 567 sq ft**

( Including restricted height  
under 1.5m )

( CH = Ceiling Heights )

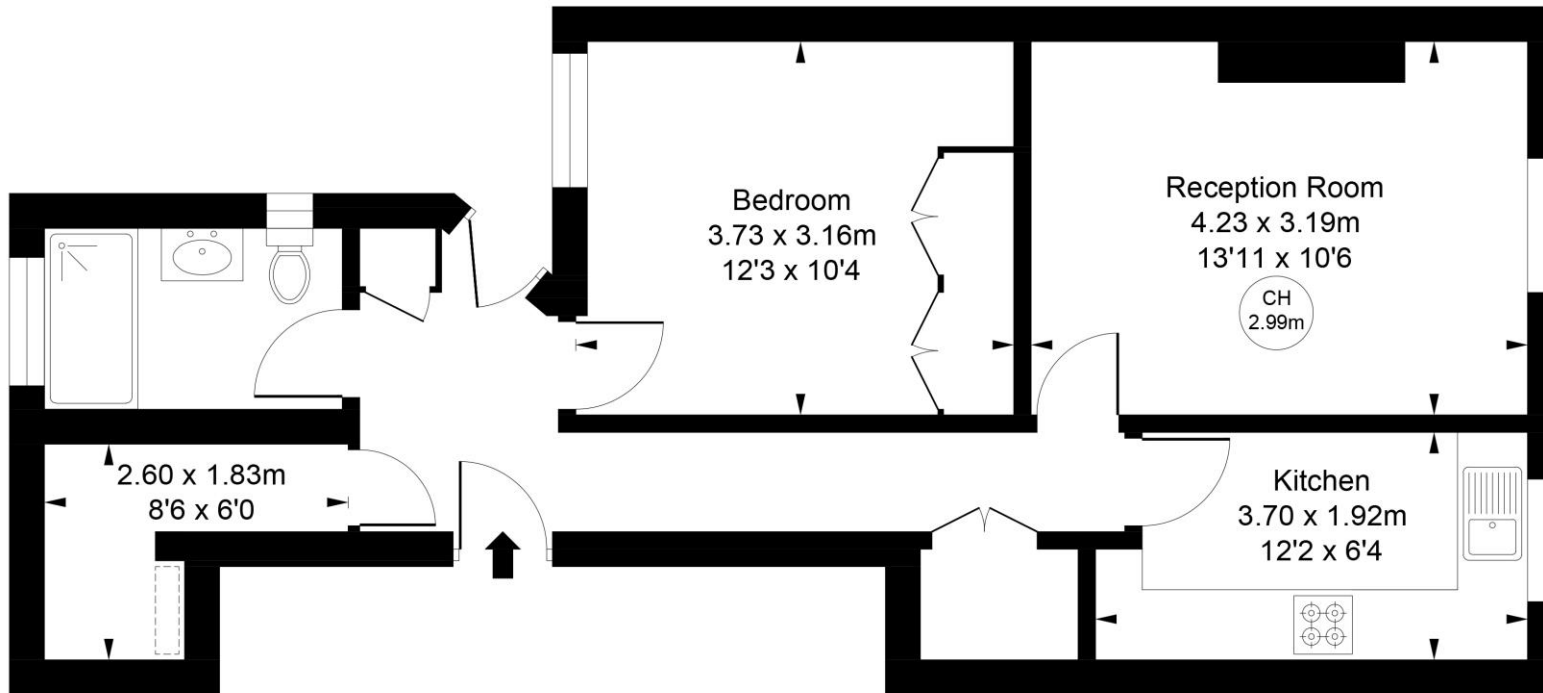

First Floor

This plan is not to scale. It is for guidance and not for valuation purposes.

All measurements and areas are approximate only, and have been prepared in accordance with the current edition of the RICS Code of Measuring Practice.

Important notice: Ashdown Marks, their clients and any joint agents give notice that: 1: They are not authorised to make or give any representations or warranties in relation to the property either here or elsewhere, either on their own behalf or on behalf of their client or otherwise. They assume no responsibility for any statement that may be made in these particulars. These particulars do not form part of any offer or contract and must not be relied upon as statements or representations of fact. 2: Any areas, measurements or distances are approximate. The text, photographs and plans are for guidance only and are not necessarily comprehensive. It should not be assumed that the property has all necessary planning, building regulation or other consents and Ashdown Marks have not tested any services, equipment or facilities. Purchasers must satisfy themselves by inspection or otherwise.

**9 Milner Street, London, SW3 2QB**

**Tel: 020 7589 3353**

**[www.ashdownmarks.co.uk](http://www.ashdownmarks.co.uk)**

**ASHDOWN MARKS**  
PROPERTY CONSULTANTS