

**King's Road, SW3**  
 Approximate Gross Internal Area  
**115.98 sq m / 1,248 sq ft**

( Including restricted height  
 under 1.5m □ □ □ □ □ )  
 ( CH = Ceiling Heights )

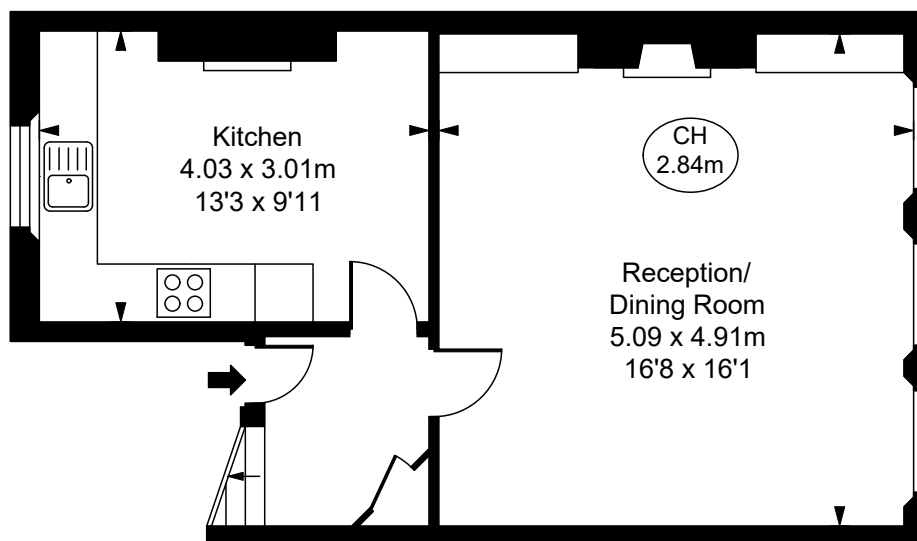

**Third Floor**  
 Approximate Gross Internal Area  
**74.45 sq m / 801 sq ft**



**Second Floor**  
 Approximate Gross Internal Area  
**41.52 sq. m / 447 sq. ft**