

Frederick Court, Duke of York Square, SW3

Approximate Gross Internal Area
54.07 sq m / 582 sq ft

(Including restricted height
under 1.5m [-----])

(CH = Ceiling Heights)

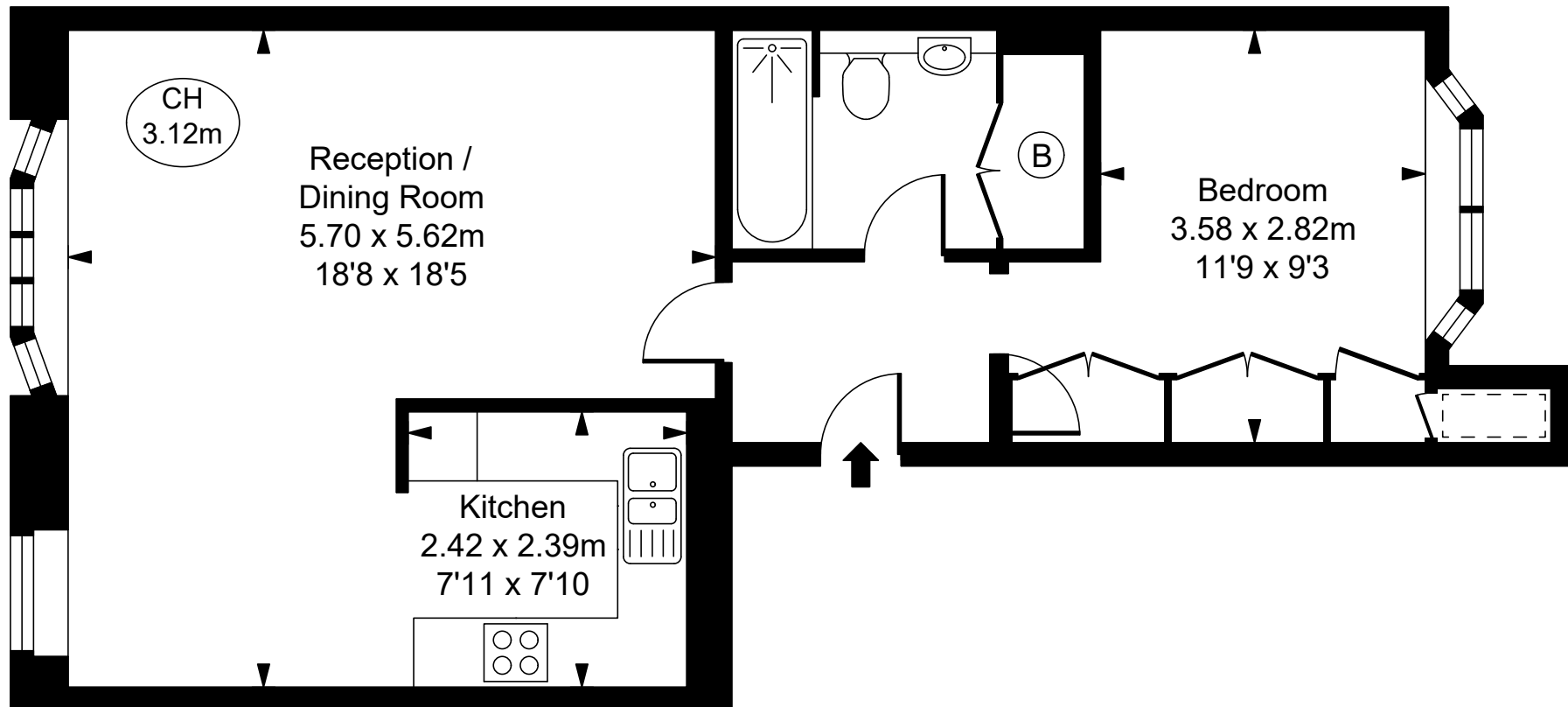
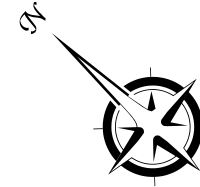

Ground Floor

This plan is not to scale. It is for guidance and not for valuation purposes.
All measurements and areas are approximate only, and have been prepared in accordance with the current edition of the RICS Code of Measuring Practice.
© Fulham Performance