

Egerton Gardens, SW3

Approximate Gross Internal Area

17.51 sq m / 188 sq ft

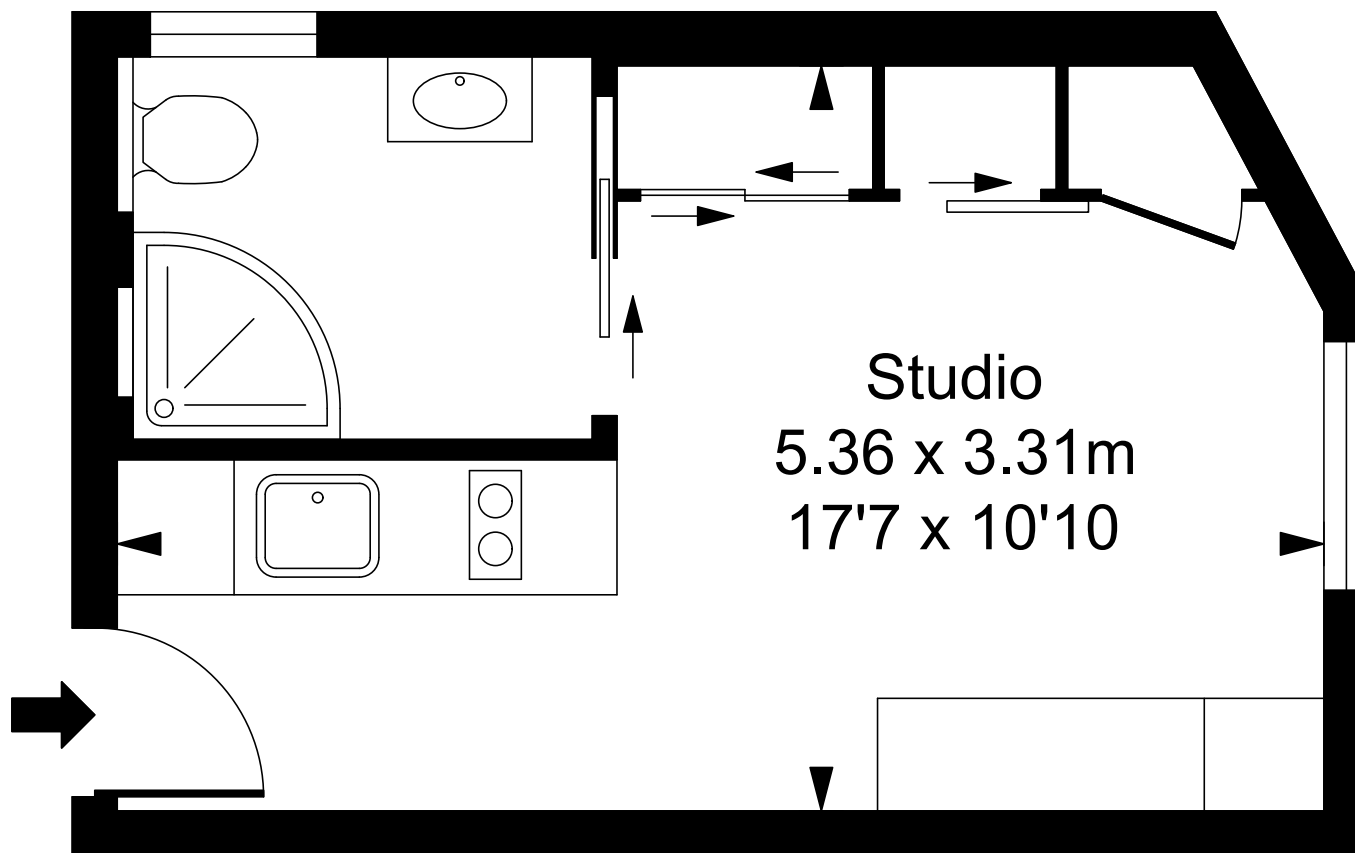

Third Floor

This plan is not to scale. It is for guidance and not for valuation purposes.

All measurements and areas are approximate only, and have been prepared in accordance with the current edition of the RICS Code of Measuring Practice.

© Fulham Performance