



Egerton Gardens, Knightsbridge SW3

ASHDOWN MARKS
PROPERTY CONSULTANTS



Egerton Gardens

Knightsbridge, SW3 2BP

A compact, well arranged studio flat located in a beautiful red brick period building with wonderful views over Egerton Gardens. Ideal as a pied a terre, it is in a leafy neighbourhood offering every amenity, yet only a few minutes walk from South Kensington tube station.

Cleverly designed to maximise the space, it features a wall bed that doubles up as a sofa when retracted, a fully fitted open plan kitchen, a shower room, under floor heating and good storage.

- Studio Room
- Shower Room
- Fully equipped open plan kitchen
- Access to communal gardens, by separate arrangement
- RBKC Council Tax - Band D
- EPC - Rating E

Lease: 998 Years plus Share of Freehold

Service Charge: 3.39% of total outgoings.

Currently £339 p.a on account, plus £1,017 reserve fund payment for internal decoration.

Guide Price: £385,000





Egerton Gardens, SW3

Approximate Gross Internal Area
17.51 sq m / 188 sq ft

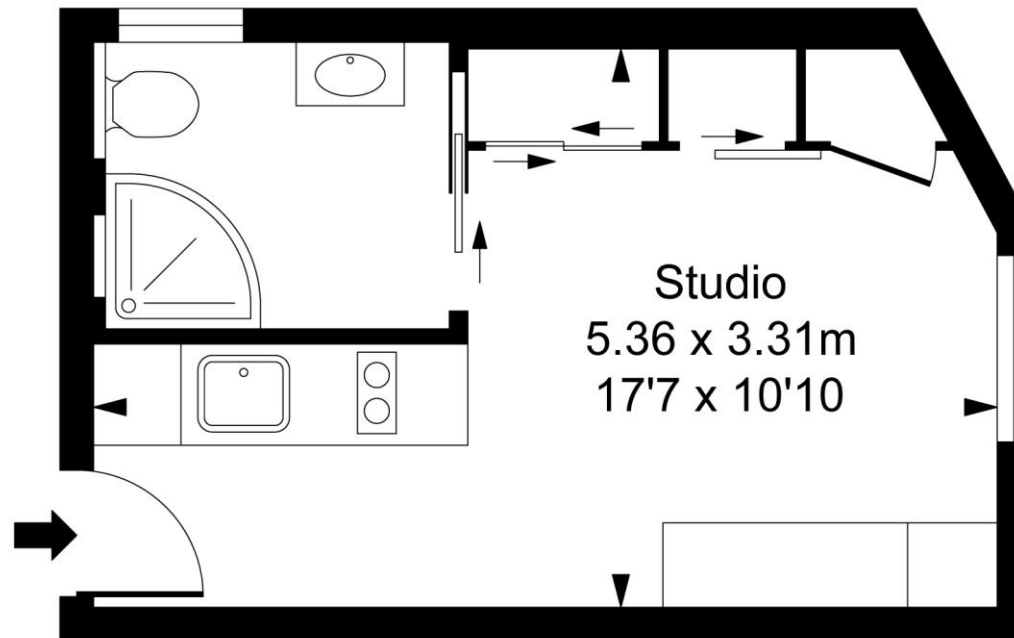

Third Floor

This plan is not to scale. It is for guidance and not for valuation purposes.
All measurements and areas are approximate only, and have been prepared in accordance with the current edition of the RICS Code of Measuring Practice.
© Fulham Performance

Important notice: Ashdown Marks, their clients and any joint agents give notice that: 1: They are not authorised to make or give any representations or warranties in relation to the property either here or elsewhere, either on their own behalf or on behalf of their client or otherwise. They assume no responsibility for any statement that may be made in these particulars. These particulars do not form part of any offer or contract and must not be relied upon as statements or representations of fact. 2: Any areas, measurements or distances are approximate. The text, photographs and plans are for guidance only and are not necessarily comprehensive. It should not be assumed that the property has all necessary planning, building regulation or other consents and Ashdown Marks have not tested any services, equipment or facilities. Purchasers must satisfy themselves by inspection or otherwise.

9 Milner Street, London, SW3 2QB

Tel: 020 7589 3353

www.ashdownmarks.co.uk

ASHDOWN MARKS
PROPERTY CONSULTANTS