



Keaton Close, Crownhill, Milton Keynes, MK8 0DS
Price £379,995 Freehold



CGI for indicative use only

Stunning brand new two bedroom detached bungalow! Nestled in a quiet cul-de-sac in the popular residential area of Crownhill. This beautifully designed bungalow offers the perfect blend of style, comfort, and sustainability.

Keaton Close

Crownhill, MK8 0DS

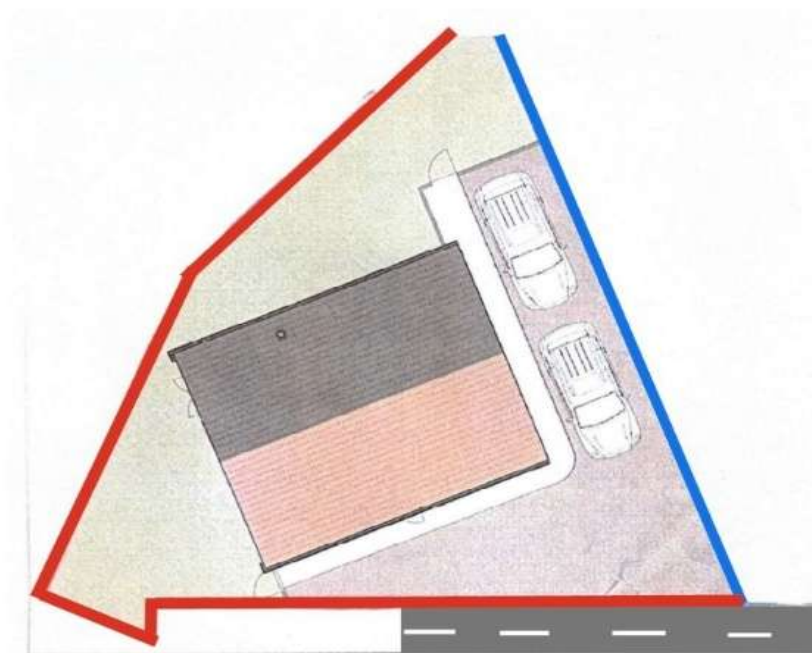

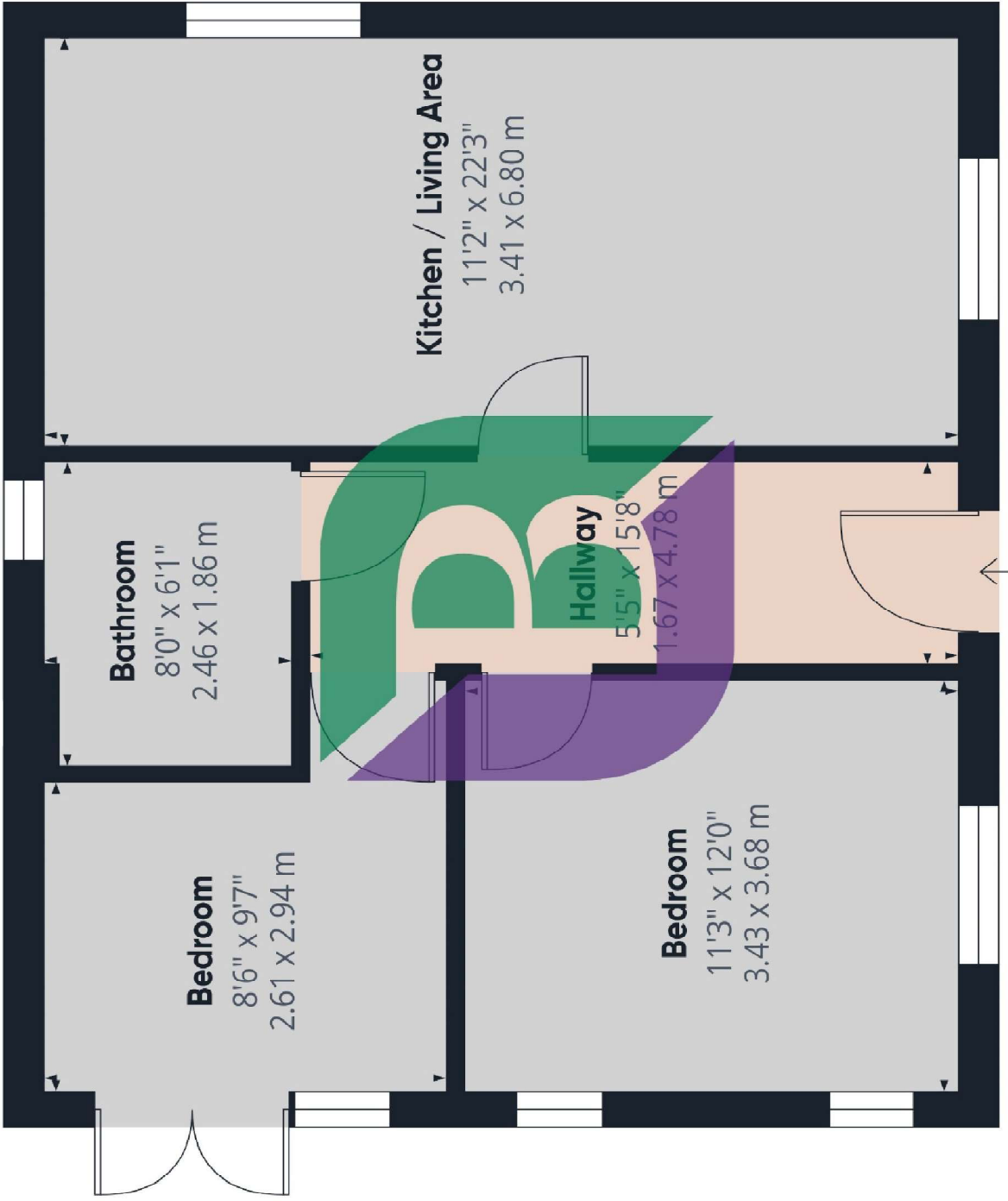

Approximate total area⁽¹⁾

616 ft²
57.2 m²

(1) Excluding balconies and terraces

Calculations reference the RICS IPMS 3C standard. Measurements are approximate and not to scale. This floor plan is intended for illustration only.

Stunning brand new two bedroom detached bungalow with new home warranty! Nestled in a quiet cul-de-sac in the popular residential area of Crownhill. This beautifully designed bungalow offers the perfect blend of style, comfort, and sustainability.

The property comprises; entrance hall, fully fitted kitchen with integrated appliances and quartz worktops, open plan living and dining space, family bathroom and two bedrooms. The property benefits from underfloor heating throughout, and will be fitted with high quality flooring.

Externally, there is a rear garden, and off-road parking for three vehicles with EV charging point.

Situated in a popular residential area, Crownhill is well-established residential in the westerly side of Milton Keynes. Crownhill has easy access to the A5, and is well-served by local bus routes, making commuting into Central Milton Keynes and beyond straightforward. For families, the area falls within the catchment of well rated schools and has access to facilities including nearby playgrounds and green open spaces.

Notice

Please note we have not tested any apparatus, fixtures, fittings, or services. Interested parties must undertake their own investigation into the working order of these items. All measurements are approximate and photographs provided for guidance only.



6 High Street
Woburn Sands
Buckinghamshire
MK17 8RL

