



Goldsmith Drive, Newport Pagnell

Price £375,000 Freehold



Located within a well regarded residential area of Newport Pagnell, The property is an attractive three bedroom family home offering well balanced accommodation, private outdoor space and excellent parking. The ground floor offers generous living space with access to the rear garden, making it ideal for both everyday living and entertaining. An integral garage provides secure parking or useful storage, while the driveway offers additional off street parking.



Goldsmith Drive

Newport Pagnell, MK16 8RS



- No Upper Chain
- Garage & Driveway
- Three Double Bedrooms
- Re Fitted Kitchen
- Re Fitted Bathroom
- Private Rear Garden
- Lounge / Diner
-



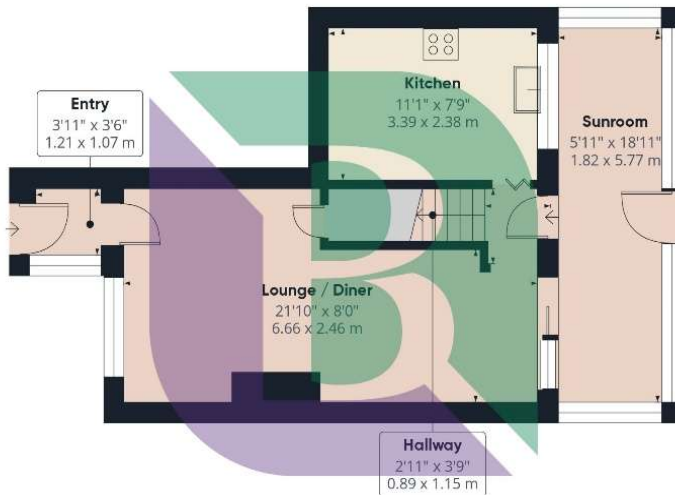

Ground Floor

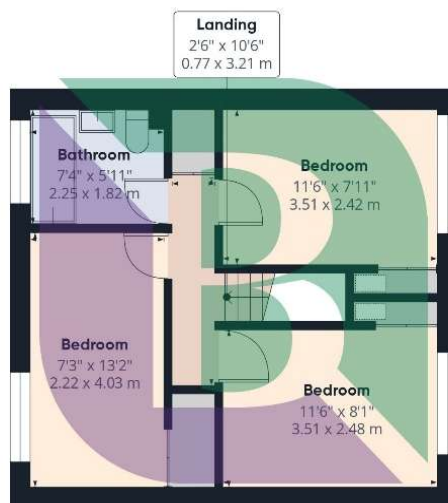

Floor 1



Approximate total area⁽¹⁾
834 ft²
77.6 m²

(1) Excluding balconies and terraces

Calculations reference the RICS IPMS 3C standard. Measurements are approximate and not to scale. This floor plan is intended for illustration only.

GIRAFFE360

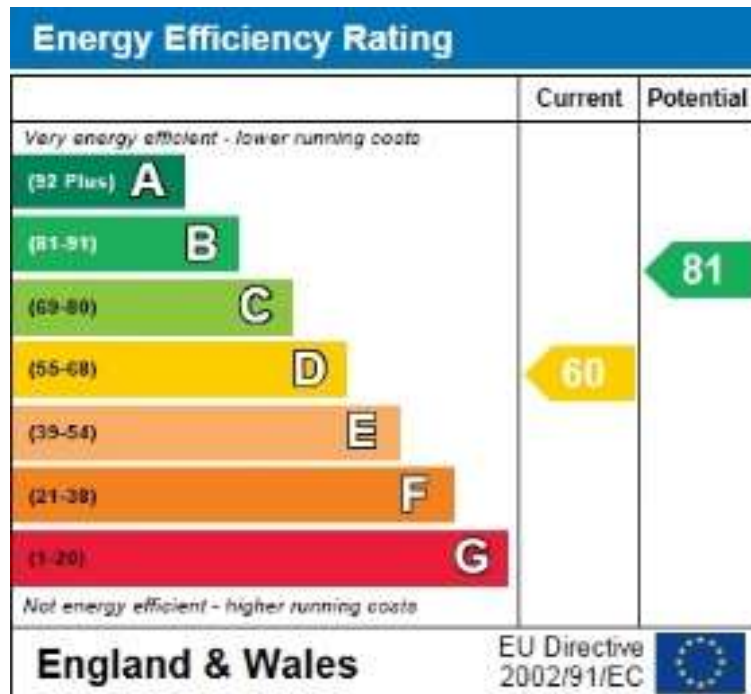

6 High Street
Woburn Sands
Buckinghamshire
MK17 8RL

Notice

Please note we have not tested any apparatus, fixtures, fittings, or services. Interested parties must undertake their own investigation into the working order of these items. All measurements are approximate and photographs provided for guidance only.

