

# Book your viewing

01962 418 070  
resales@pegasushomes.co.uk



# Marlborough *Fleur-de-Lis*

APARTMENT 27



Lease term	Leasehold
	242 years remaining 250 years from the 1st February 2017
Service charge	£5,605 per annum Reviewed annually
Ground rent	£595 per annum
Ground rent review date	February 2027 Ground rent reviewed as of 1st February 2022 and every fifth anniversary thereafter.
Council tax banding	D
EPC	B

Score

Energy rating

Current

Potential

92+

A

81-91

B

69-80

C

55-68

D

39-54

E

21-38

F

1-20

G

Exclusively for those over 60



London Road  
Marlborough  
Wiltshire  
SN8 2FN

Buy for  
£360,000



Discover a new lease of life in a beautiful city,  
village or coastal location across England.  
[pegasushomes.co.uk](https://pegasushomes.co.uk)

The floor plan is for illustrative purposes only. It is not drawn to scale. Any measurements, openings and orientation are approximate. No details are guaranteed, they can't be relied upon for any purpose and they do not form part of any agreement. No liability is taken for any error, omission or misstatement. A party must rely upon their own inspection. These details are produced for guidance purposes only and complete accuracy can't be guaranteed. If there is any particular point which is of importance to you, we recommend verification should be obtained. These details do not constitute a contract or part of a contract. No apparatus, equipment, fixture or fittings have been tested. Items shown in photographs are not necessarily included in the sale. Please check availability and make an appointment to view before travelling to see a property to avoid any wasted time or travel cost. Imagery shown is photography of Marlborough and indicative only. Prices shown are correct at time of publication and may be subject to change. Prices shown are exclusive of service charge, which is payable monthly and is reviewed annually. For full terms visit [pegasushomes.co.uk/company/legal/terms-and-conditions/](https://pegasushomes.co.uk/company/legal/terms-and-conditions/)







# Marlborough Fleur-de-Lis

APARTMENT 27

EXCLUSIVELY FOR THOSE OVER 60

Book your viewing 01962 418 070 | [resales@pegasushomes.co.uk](mailto:resales@pegasushomes.co.uk)

## Details

Buy for  
£360,000

A safe and secure later living community created exclusively for those over 60, Fleur-de-Lis Marlborough is set close to the heart of the bustling Wiltshire market town.

Apartment 27 is a stunning two bedroom home within a secure, gated development, located on the second floor overlooking the bowling green with its southerly aspect. Presented in excellent condition this beautifully maintained, versatile home offers bespoke fitted furniture in the living room and the second bedroom / reception room. The kitchen is fully integrated with NEFF appliances and has high quality Silestone work surfaces. Two luxury shower rooms, one being an ensuite are fitted with Premium Villeroy & Boch sanitary ware.

This charming community also boasts a communal lounge and beautifully landscaped gardens, where residents can enjoy social gatherings and events from weekly coffee mornings, film and board game evenings and so much more.

## Highlights

- Landscaped gardens
- Communal lounge
- Lift to all floors
- Guest suite
- Friendly on-site team
- Close to the high street
- Parking (£250 per annum) subject to availability
- 24-hour emergency call system

## Floorplan

Second Floor

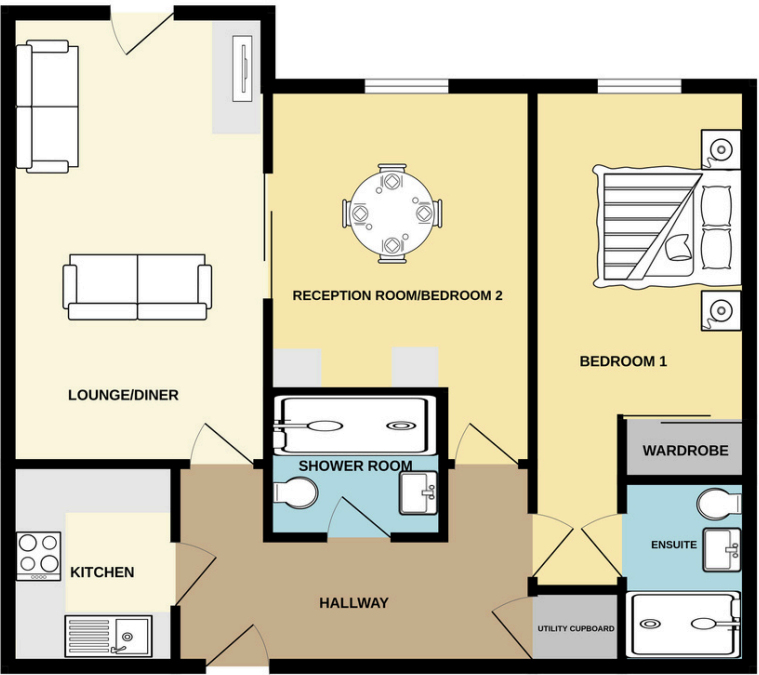

Lounge / Diner	17'9 x 10'2"
Kitchen	7'10 x 6'7"
Bedroom 1	15'5 x 8'10"
Ensuite	7'3 x 4'11"
Bedroom 2	12'2 x 10'2"
Shower Room	6'11 x 5'9"
Total Area	728 sq ft



Clockwise | Lounge / Diner | Kitchen | Bedroom 2 | Shower Room



Clockwise | View over the bowling green | Communal lounge | Landscaped gardens