

Approximate Floor Area = 109.4 sq m / 1177 sq ft

Garage = 14.2 sq m / 153 sq ft

Total = 123.6 sq m / 1330 sq ft

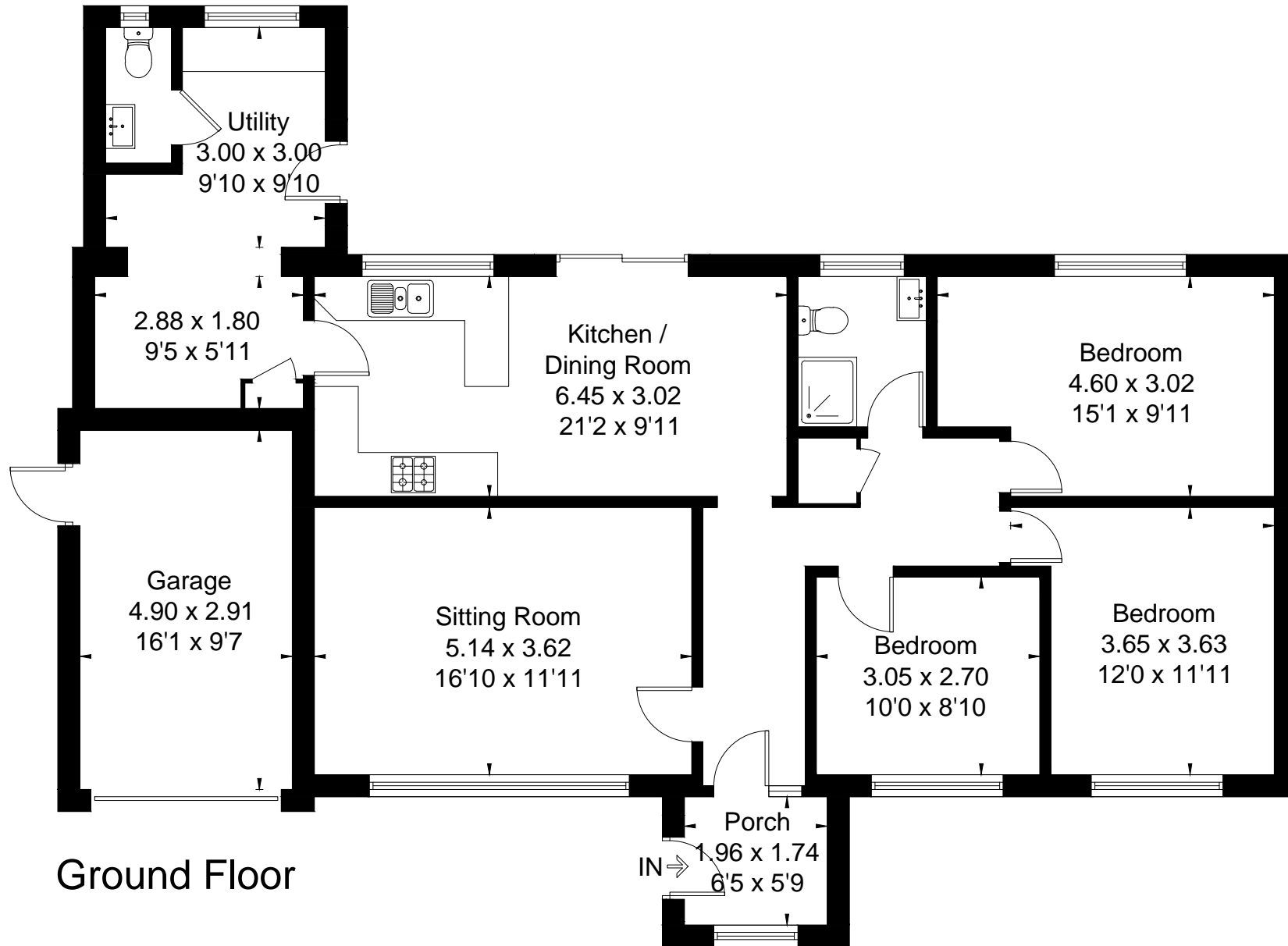

Ground Floor



This floor plan has been drawn in accordance with RICS Property Measurement 2nd edition.

All measurements, including the floor area, are approximate and for illustrative purposes only. @fourwalls-group.com #109125