

Approximate Floor Area = 71.3 sq m / 767 sq ft

Garage = 12.7 sq m / 137 sq ft

Total = 84.0 sq m / 904 sq ft

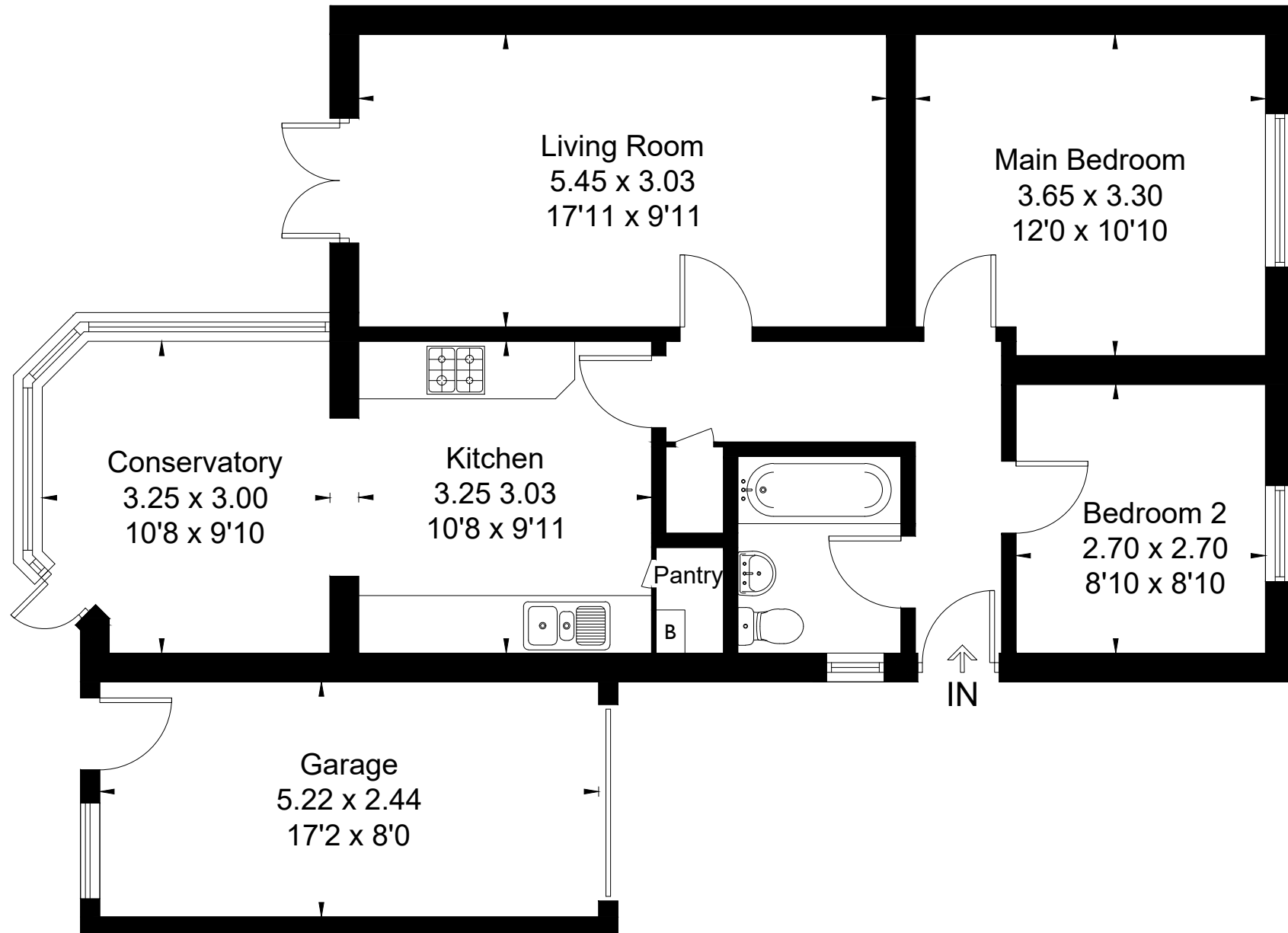

This floor plan has been drawn in accordance with RICS Property Measurement 2nd edition.

All measurements, including the floor area, are approximate and for illustrative purposes only. @fourwalls-group.com #66529