



Hemdean Road
Caversham | Berkshire

BRIDGES
Independent Estate Agents
EST. 1993



Situated in the heart of Caversham is this stunning four bedroom Victorian terrace house that has been refurbished and extended to a high specification and is brimming with character appeal. The deceptively large property benefits from well planned accommodation over three floors including a superb 24ft open plan kitchen/dining/living room with a modern sliding door system to the garden, a large central island and high quality integrated appliances. Furthermore, there is a good sized dining room, a utility room and downstairs cloakroom. The landing boasts two double bedrooms, the master with bespoke built-in wardrobes and the second enjoying far reaching views. The bathroom is well appointed, benefiting from a large bath and walk in shower. The second floor leads to two further double bedrooms and a shower room. Outside, the quiet rear garden approaches 70ft in length with a paved terrace. Bustling Caversham with its range of excellent restaurants and bars is a short walk and Reading mainline railway station is within striking distance. An early viewing is highly recommended to fully appreciate this wonderful home.



- Stunning four bedroom Victorian terrace
- Superb accommodation over three floors
- Open plan kitchen/family room
- Private 65ft rear garden

- Within striking distance of Reading Station
- Brimming with character appeal
- Cloakroom and utility room
- Immaculate throughout

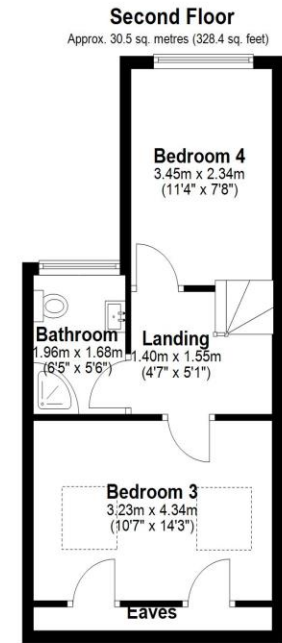
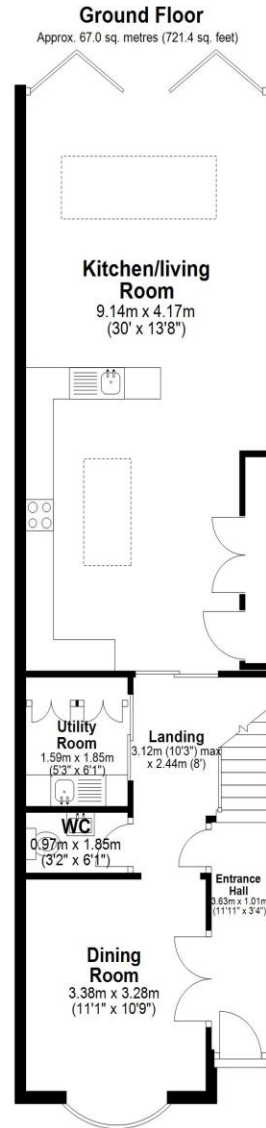

Total area: approx. 133.6 sq. metres (1438.5 sq. feet)

These floor plans are not to scale and are for guidance purposes only
Plan produced using PlanUp.