



## 41 School Lane, Merry Hill, WD23 1BY

**A 2 BEDROOM END OF TERRACE HOUSE  
IN NEED OF COMPLETE MODERNISATION  
2 RECEPTION ROOMS, KITCHEN  
GROUND FLOOR BATHROOM  
2 DOUBLE BEDROOMS, LOFT ROOM  
COURTYARD GARDEN  
SOUGHT AFTER RESIDENTIAL LOCATION  
OFFERED FOR SALE WITH NO UPPER CHAIN**

**Price £380,000 Freehold**

Colin Pearce FNAEA

Over 70 Years Combined Experience in Residential Estate Agency

John Slager FNAEA

**020-8950-0033**

[www.churchillsbushey.co.uk](http://www.churchillsbushey.co.uk)

## RECEPTION ROOM 1

12'3" (3.73m) x 11'9" (3.58m)  
Wooden front entrance door,  
glazed window to the front bay,  
electric fire



## RECEPTION ROOM 2

13'5" (4.09m) x 12'3" (3.73m)  
Staircase to first floor, electric fire,  
parquet flooring, glazed door  
leading to garden



## KITCHEN

7'9" (2.36m) x 6'4" (1.93m)  
Wall and base units, working  
surfaces, stainless steel sink unit  
with drainer, glazed windows to  
the side



## GROUND FLOOR BATHROOM

Panelled bath, wash hand basin,  
low flush wc, electric wall heater,  
window to the rear



## FIRST FLOOR LANDING

## BEDROOM 1

12'6" (3.81m) x 10'8" (3.25m)  
Window to the rear, airing  
cupboard housing hot water  
cylinder



## BEDROOM 2

12'6" (3.81m) x 9'9" (2.97m)  
Window to the front, night storage  
heater, staircase to 2nd floor

## SECOND FLOOR

## LOFT ROOM

10'9" (3.28m) x 13'0" (3.96m)  
double glazed window to the side

## OUTSIDE

## REAR GARDEN

Courtyard garden with rear  
pedestrian access

**COUNCIL TAX**

Hertsmere Borough Council

Tax Band D

£1947.21 2022/2023





Ground Floor

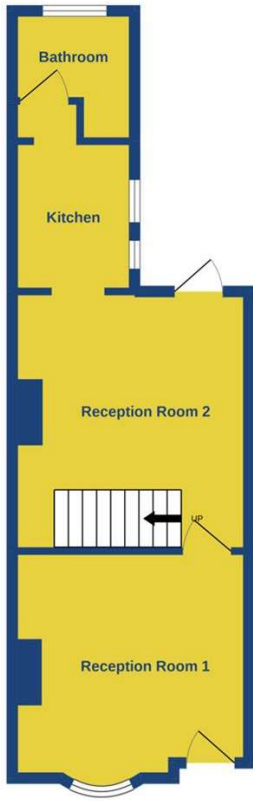

1st Floor

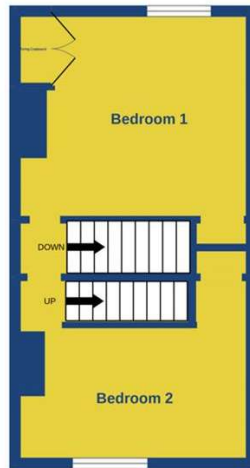

2nd Floor



Whilst every attempt has been made to ensure the accuracy of the floorplan contained here, measurements of doors, windows, rooms and any other items are approximate and no responsibility is taken for any error, omission or mis-statement. This plan is for illustrative purposes only and should be used as such by any prospective purchaser. The services, systems and appliances shown have not been tested and no guarantee as to their operability or efficiency can be given.  
Made with Metropix ©2022

**ENERGY PERFORMANCE  
GRAPH**

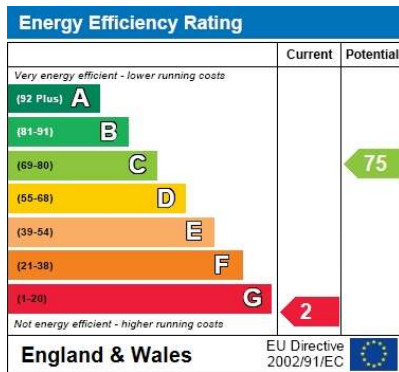

Churchills Independent Estate Agents have prepared these particulars/plans as accurately and reliably as possible, as a guide to prospective purchasers. Any points of concern arising from the particulars/plans should be clarified with this office before travelling some distance to view the property. Measurements are approximate and subject to variation and must not be relied on for the purpose of ordering carpets, furnishings etc. No person in the employ of Churchills Independent Estate Agents has any authority to make or give any representation or warranty whatsoever in relation to this property or its fittings. None of the statements contained in these particulars are to be relied on as statements of representations of fact.

Further details of all our properties can be obtained by visiting our web site at : [www.churchillsbushey.co.uk](http://www.churchillsbushey.co.uk)