

David Doyle

 **MAYFAIR**
OFFICE.CO.UK

4 Sebright Road

Hemel Hempstead, Hertfordshire

- Premier Boxmoor side road.
- Open plan Lounge/Dining room.
- High specification Kitchen.
- Luxurious Family Bathroom and Ensuite Shower Room.
- Driveway providing excellent off road parking facilities.
- Private rear gardens.
- Double glazing and gas heating to radiators.

Offers in Excess of

£600,000



Tel: 01442 248671

www.daviddoyle.co.uk

boxmoor@daviddoyle.co.uk

Call **01442 248671** to arrange a viewing or register an



Ground Floor Building 1



Floor 1 Building 1

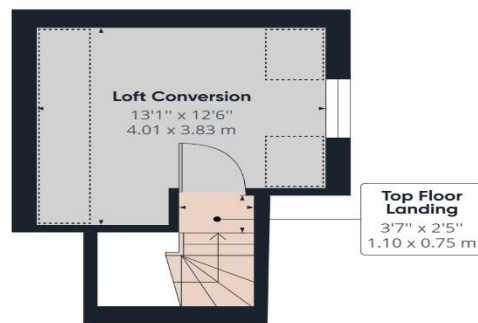

Floor 2 Building 1

Approximate total area⁽¹⁾

882.60 ft²
82.00 m²

Reduced headroom

49.73 ft²
4.62 m²

(1) Excluding balconies and terraces

Reduced headroom
(below 1.5m/4.92ft)

While every attempt has been made to ensure accuracy, all measurements are approximate, not to scale. This floor plan is for illustrative purposes only.

GIRAFFE360

4 Sebright Road

Hemel Hempstead, Hertfordshire



45 St Johns Road
Boxmoor
Hemel Hempstead
HP1 1QQ
01442 248671