



14 Restharrow, Lansdowne Gardens, Bournemouth, BH1 1QR
Guide Price £85,000 Leasehold

AUTHENTIC ~ PASSIONATE ~ PROFESSIONAL
Tel: 01202 551022 | Email: inf@fahren.co.uk | Web: www.fahren.co.uk

Lansdowne Gardens, Bournemouth

Guide Price £85,000

1 bedroom apartment | Garden access | Modern kitchen | Modern bathroom | Patio | Double bedroom | Over 55s | Retirement Home | Sought After Location | No Chain



0



Apartment



1



431 sqft (40 sqm)



1



Leasehold





Lansdowne Gardens, Bournemouth

Guide Price £85,000

Fahren

GUIDE PRICE £85,000

OVER 55s INVESTMENT OPPORTUNITY

Fahren Estate Agents are delighted to present to the market this fantastic opportunity of a 1 bedroom ground floor investment property for the over 55s. T

Restharrow is a retirement development located just a short walk from Bournemouth town centre. The development consists of 65 apartments, a 24hr emergency response facility, large communal parking area and visitor parking, as well as landscaped communal gardens and well sized bin stores. Internally the development boasts a house manager, communal lounge and small kitchen for tea / coffee making where a number of social events are run on a weekly basis.

The apartment is situated on the ground floor of this retirement

block, and it has patio door access to the communal gardens.

On entering the apartment you are welcomed into a hallway providing access to 2 storage cupboards, the lounge/kitchen, the bedroom and the shower room. The open plan lounge kitchen is a good size room and has a large window and door overlooking the gardens. The bedroom is a double and benefits from built in wardrobes.

Service charge: £240 per month

Ground rent: £61.79 half yearly

Leasehold with Date : 20 July 2023

Term : 215 years from 1 March 1990

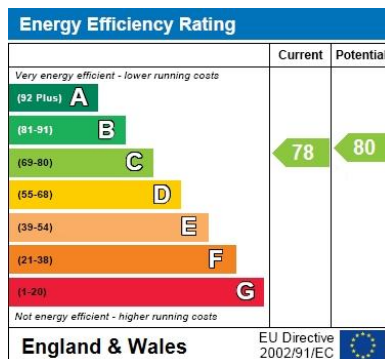

Connect with us



If you would like to book a viewing or find out how much your property is worth please contact us

Tel: 01202 551022

Email: inf@fahren.co.uk

Web: www.fahren.co.uk

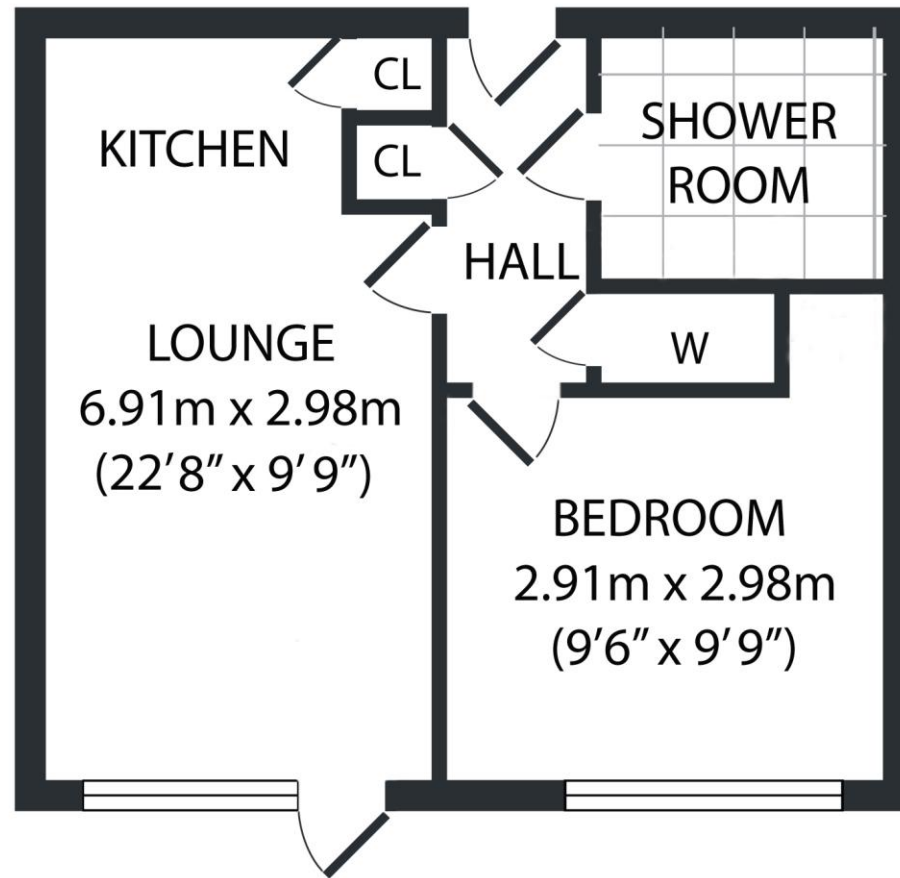

Total area : approx. 40 sq. meters (431 sq. feet)

This floor plan is for illustrative purposes and layout guidance only. It is not drawn to scale.
Dimensions should not be used for carpet or flooring sizes and are not intended to form part of any contract.