



Fahren
ESTATE AGENTS

Flat 36 Midland Heights, 51 Norwich Avenue West, Bournemouth, BH2 6AJ
Price £130,000 Leasehold

AUTHENTIC ~ PASSIONATE ~ PROFESSIONAL
Tel: 01202 551022 | Email: inf@fahren.co.uk | Web: www.fahren.co.uk

Norwich Avenue West, Bournemouth

Price £130,000

ONE BEDROOM APARTMENT | GREAT FIRST TIME BUY OR BUY TO LET |
MODERN KITCHEN | SHOWER ROOM | LOFT | BIKE STORE | VACANT
POSSESSION AND NO CHAIN | IDEAL LOCATION BETWEEN BOURNEMOUTH
AND WESTBOURNE | TOP FLOOR |



0



Apartment



1



344 sqft (32 sqm)



1



Leasehold





Norwich Avenue West, Bournemouth

Price £130,000

Fahren

Fahren Estate Agents are delighted to present this spacious one bedroom unique character flat with no chain, a well proportioned lounge, long lease, convenient location and offered with vacant possession.

Midland Heights was originally the railway hotel for Bournemouth West station. The property is ideally situated within equal distance of both Bournemouth town centre and Westbourne whilst the West cliff and beaches are approximately 3/4 of a mile distant. There is a Co-Op convenience store and council parking opposite on Queens Road. The surrounding roads are mainly non restricted on road parking.

The flat is accessed via a security entry phone with stairs to all floors. The apartment is located on the top floor of the block.

The apartment comprises a modern fitted kitchen with hob and oven, washing machine and under-counter fridge. There is a modern shower room, loft storage, good size bedroom and a cozy living room

Service charge: £ 1,852.32 per annum (£232.56 of this is reserve fund)

Annual Ground Rent: £195

Council Tax Band: A

Lease: 114 years

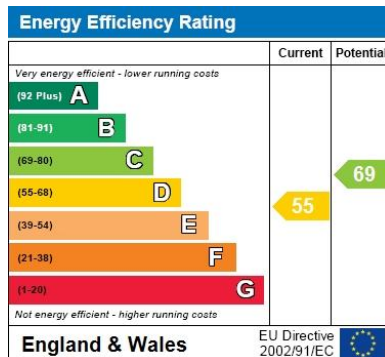

Connect with us



If you would like to book a viewing or find out how much your property is worth please contact us

Tel: 01202 551022

Email: inf@fahren.co.uk

Web: www.fahren.co.uk





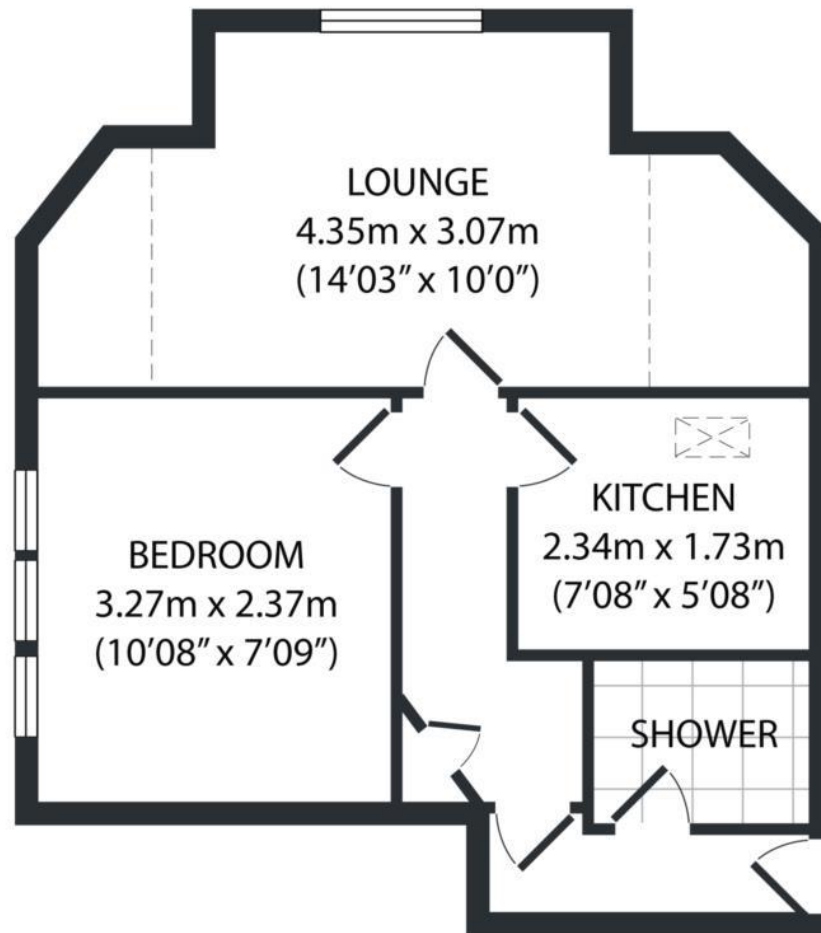

Total area : approx. 25.13 sq. meters (270.4 sq. feet)

This floor plan is for illustrative purposes and layout guidance only. It is not drawn to scale. Dimensions should not be used for carpet or flooring sizes and are not intended to form part of any contract.