

GROUND FLOOR
APPROX. FLOOR
AREA 589 SQ.FT.
(54.7 SQ.M.)

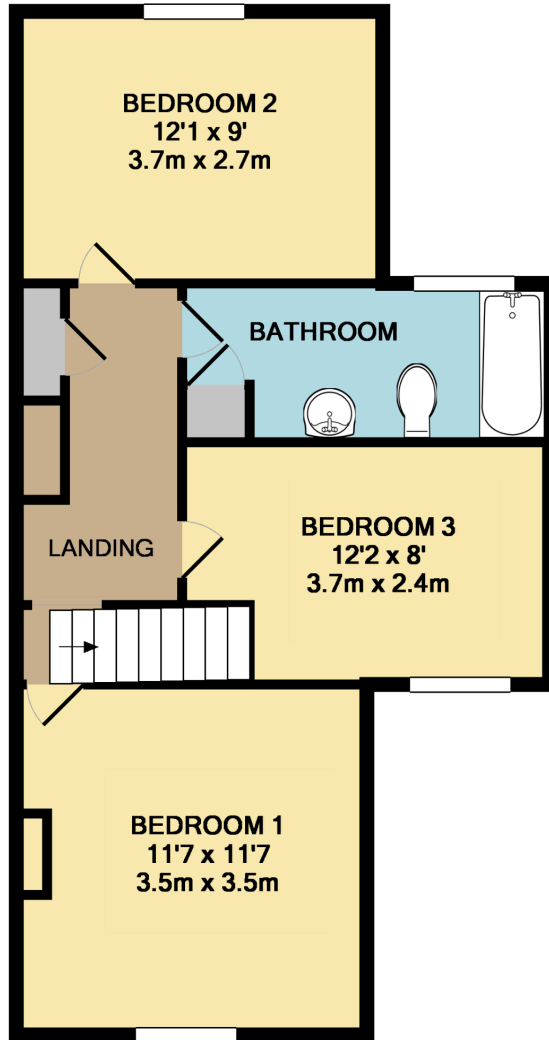

1ST FLOOR
APPROX. FLOOR
AREA 476 SQ.FT.
(44.3 SQ.M.)

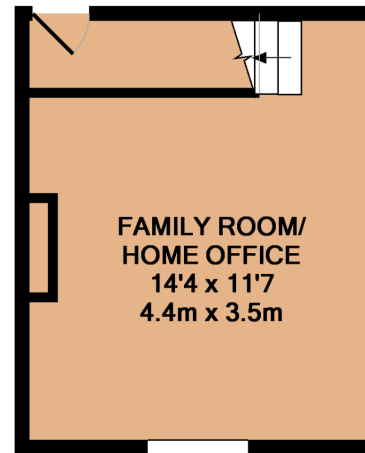

BASEMENT LEVEL
APPROX. FLOOR
AREA 166 SQ.FT.
(15.4 SQ.M.)



TOTAL APPROX. FLOOR AREA 1231 SQ.FT. (114.4 SQ.M.)

Made with Metropix ©2018