



2 Lime House, Cookswell, Shillingstone, Dorset, DT11 0QZ



A well presented one bedroom apartment situated in the popular village of Shillingstone, offered to the market with NO FORWARD CHAIN.

A stylish and contemporary first floor apartment presented to the market with the advantage of no onward chain, enjoying rural views and located in the popular and well served village of Shillingstone.

The village itself offers a primary school, public house, petrol station with shop plus a Coop convenience store above which the apartment is situated.

The apartment has been completed to a very high standard benefiting from UPVC double glazing throughout, wall mounted electric heaters and comes with vinyl flooring to the main living areas, tiled bathroom floors and carpet in the bedroom.

The sleek kitchen has also been fitted with integral appliances, which includes fridge/freezer, oven and hob with extractor hood over and a wash/dryer. The apartment provides an excellent home for those looking to purchase their first property or even as a weekend/holiday or lock up and leave UK base.

In brief, the accommodation consists of external staircase rising to the main door, which opens into the hall leading to four apartments. Flat 2's front door is on the left hand side at the beginning of the hall.

Front door opens into the entrance hall, panelled doors to the bedroom, bathroom into the plan living and kitchen area, which enjoys a double outlook with skylights to the front and large window to the side with field views. Outside there is a bin store and an allocated parking space.

Notes:

Lease - 125 years from 2018

Service Charge – £1,300 Approx

Ground Rent - £250 PA

£122,500 Leasehold

2 Lime House

Approximate Gross Internal Area
710 sq ft - 66 sq m

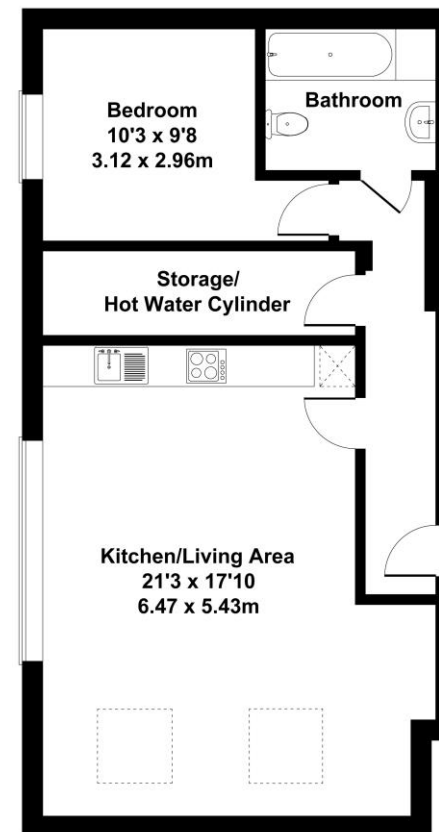

Not to Scale. Produced by The Plan Portal 2025
For Illustrative Purposes Only.

Please note Forum Sales & Lettings and their client give notice that:

1. They have no authority to make or give any representation or warranties in relations to the property. These particulars do not form part of any offer or contract and must not be relied upon as statements or representations of fact.
2. Any areas, common measurements or distances are approximate. The text, photographs and plans are for guidance only and are not necessarily comprehensive. It should not be assumed that the property has all necessary Planning, Building Regulations or other consents and Forum Sales and Lettings have not tested any services, equipment or facilities. Purchasers must satisfy themselves by inspection or otherwise.

EPC Rating - D

Viewing Arrangements - Strictly by appointment with Forum Sales & Lettings

15 Salisbury Street, Blandford Forum, Dorset, DT11 7AU

Tel: 01258 459600