

Acacia Grove New Malden KT3



- **Two Bedrooms**
- **Spacious Living Toom**
- **Separate Eat-in Kitchen**
- **Close to Station and High Street**
- **Residents Parking**

Price £1,600 pcm

A large, first floor maisonette which has just been repainted and offers spacious accommodation throughout. The property has its own private entrance and there is a large living room to the front. a good size kitchen/breakfast room, two bedrooms and a bathroom as well as residents parking to the rear on a first come, first served basis. Set on this popular road in 'The Groves' just a short walk from both the High Street and station as well as local schools. The property is available now and unfurnished. EPC rating C. Council tax band C. Security deposit £1,846 (based on the asking price).



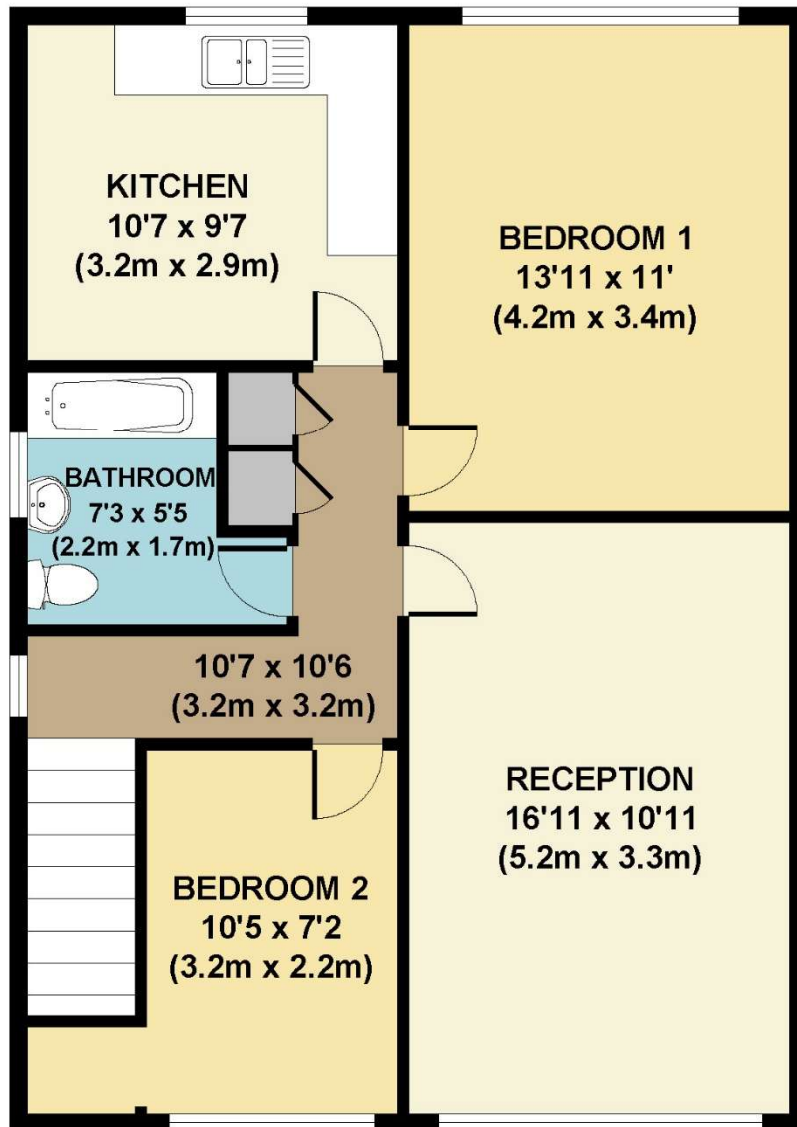

**FIRST FLOOR
GROSS INTERNAL
FLOOR AREA 680 SQ FT**

APPROX. GROSS INTERNAL FLOOR AREA 680 SQ FT / 63 SQ M
 Floorplans are for identification and guideline purposes only, not to scale.
 Compliant with RICS code of measuring practice.
 Floorplans supplied by www.draftingfloorplan.com

