

Archdale Place New Malden KT3



- **Just Renovated**
- **Three Bedroom Family Home**
- **Off Street Parking**
- **Private rear Garden**
- **En Suite Master Bedroom**

Price £2,500 pcm

A newly refurbished bright and airy modern property which is located within easy reach of both New Malden and Kingston town centres. The ground floor comprises a brand new large kitchen with includes a dishwasher and a rear reception room which has sliding doors leading out onto the rear garden; additionally, there is a ground floor W/C. The first floor has a master bedroom with en-suite shower room, a family bathroom and two further bedrooms and there is off street parking to the front. This house is available now and unfurnished. Council tax band E. Security deposit £2,884 (based on the asking price). EPC rating D.



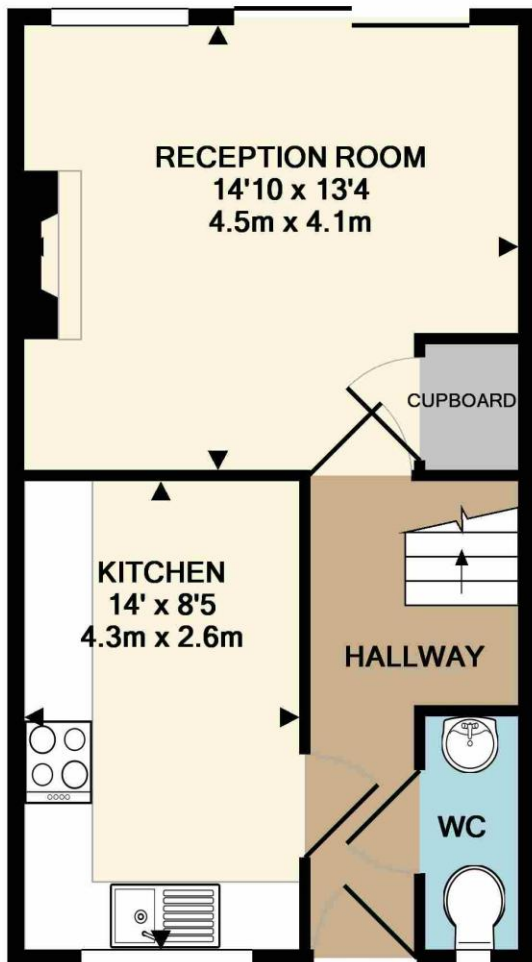

GROUND FLOOR
APPROX. FLOOR
AREA 404 SQ.FT.
(37.6 SQ.M.)

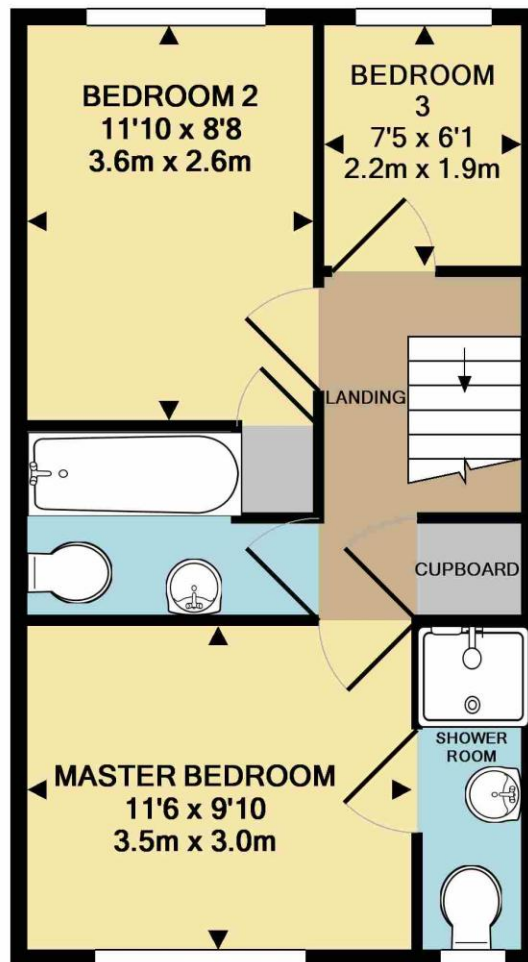

1ST FLOOR
APPROX. FLOOR
AREA 404 SQ.FT.
(37.6 SQ.M.)

TOTAL APPROX. FLOOR AREA 809 SQ.FT. (75.1 SQ.M.)

Whilst every attempt has been made to ensure the accuracy of the floor plan contained here, measurements of doors, windows, rooms and any other items are approximate and no responsibility is taken for any error, omission, or mis-statement. This plan is for illustrative purposes only and should be used as such by any prospective purchaser. The services, systems and appliances shown have not been tested and no guarantee as to their operability or efficiency can be given

Made with Metropix ©2017

