

## Kingston Road New Malden KT3



- Large One Bedroom Ground Floor Flat
- Kitchen/Breakfast Room
- Private Parking
- Communal Gardens

**£1,100 pcm**

A larger than average bright one bedroom ground floor flat in a small modern block with private parking and communal garden. The flat has a large reception room with v-shaped window, a good sized kitchen/breakfast room, double bedroom with jack and jill bathroom. The property is situated within easy walking distance of New Malden High Street and Station as well as having excellent access to bus routes to both Kingston and Wimbledon. The property is available now and unfurnished. Viewing highly recommended. EPC rating E.

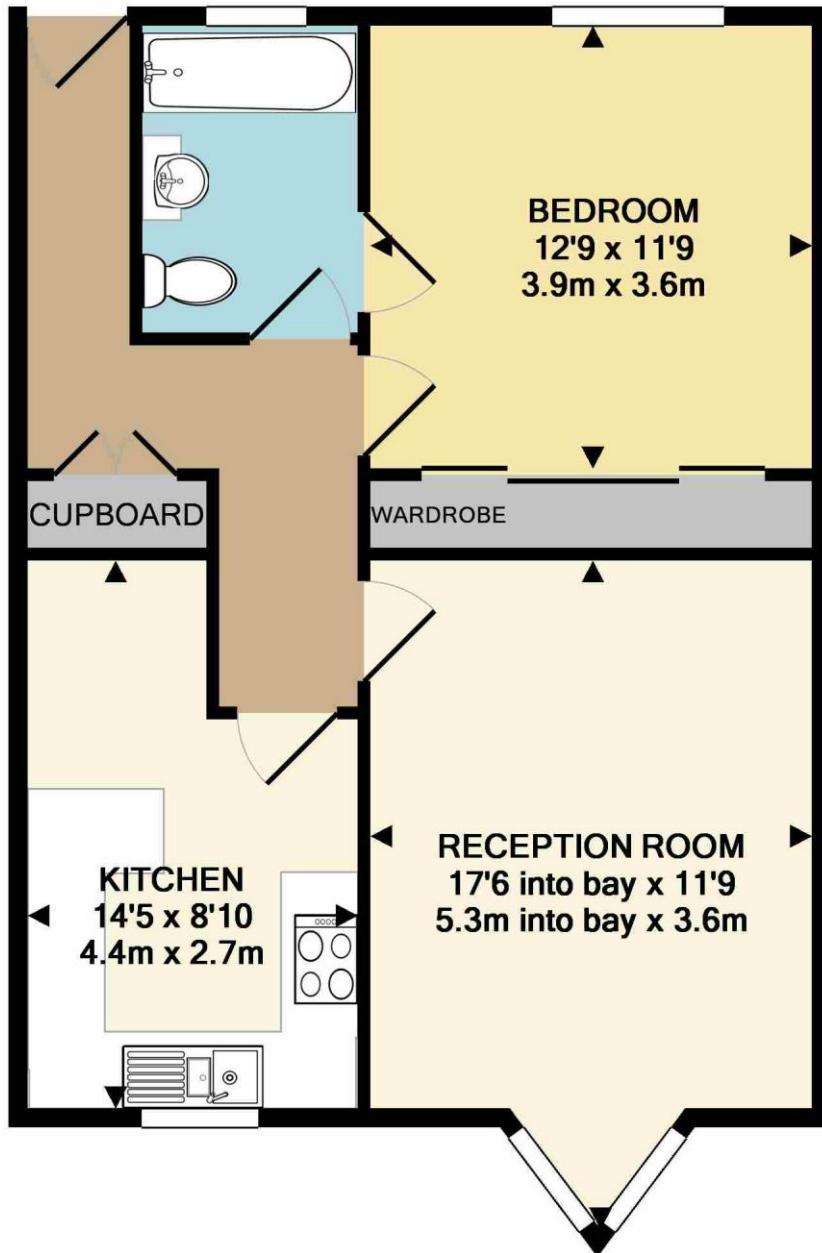

TOTAL APPROX. FLOOR AREA 591 SQ.FT. (54.9 SQ.M.)

Whilst every attempt has been made to ensure the accuracy of the floor plan contained here, measurements of doors, windows, rooms and any other items are approximate and no responsibility is taken for any error, omission, or mis-statement. This plan is for illustrative purposes only and should be used as such by any prospective purchaser. The services, systems and appliances shown have not been tested and no guarantee as to their operability or efficiency can be given

Made with Metropix ©2017



