

Green Lane New Malden KT3



- **Newly Refurbished**
- **Three Bedrooms**
- **Two reception rooms**
- **New Modern Kitchen and Bathroom**

Price £2,400 pcm

Beautifully presented and newly refurbished and decorated three bedroom house with off street parking, well located within walking distance of local K1 and 131 bus routes to Kingston and Berrylands station, local shops, recreation ground and easy access to A3. There is also the added benefit of being in the catchment area for the local primary and secondary schools as well as Westbury House Preparatory School, The Study and Christ Church C of E all nearby. The property comprises a good size front sitting room, dining room and modern fitted kitchen which includes a dishwasher and Blomberg washing machine and Bosch oven. On the first floor are two good size double bedrooms and one single bedroom and the modern fully tiled family bathroom with shower over bath with screen and large mirror. The property additionally benefits from period decorative fireplaces, new flooring downstairs, gas central heating through out and a storage shed in the garden. The home has well maintained low maintenance gardens and double glazing throughout. Available now and unfurnished. Security deposit £2,769 (based on the asking price). Council tax band D. EPC rating C.



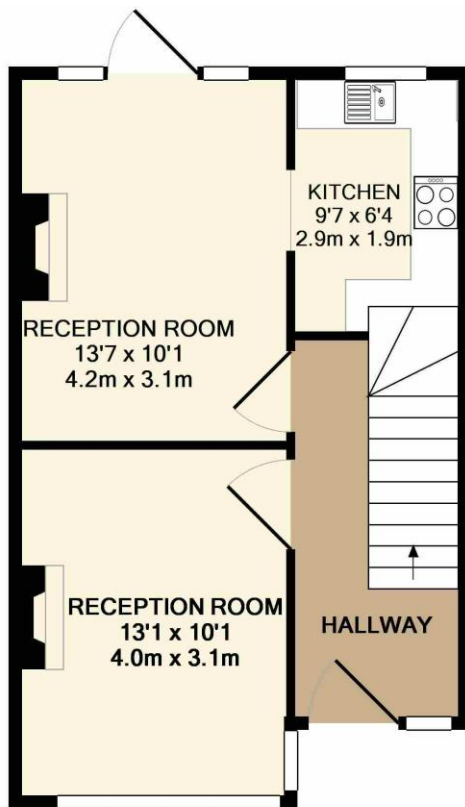

GROUND FLOOR
APPROX. FLOOR
AREA 420 SQ.FT.
(39.0 SQ.M.)

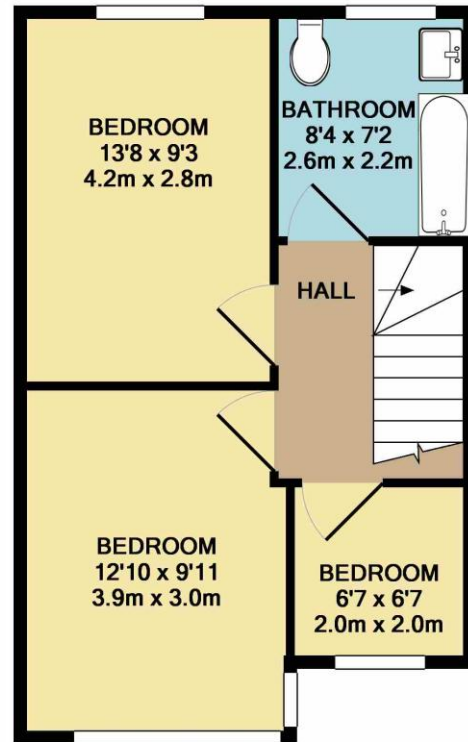

1ST FLOOR
APPROX. FLOOR
AREA 418 SQ.FT.
(38.9 SQ.M.)

TOTAL APPROX. FLOOR AREA 838 SQ.FT. (77.9 SQ.M.)

Whilst every attempt has been made to ensure the accuracy of the floor plan contained here, measurements of doors, windows, rooms and any other items are approximate and no responsibility is taken for any error, omission, or mis-statement. This plan is for illustrative purposes only and should be used as such by any prospective purchaser. The services, systems and appliances shown have not been tested and no guarantee as to their operability or efficiency can be given
Made with Metropix ©2018







