



## Willow Road New Malden KT3



- **A Modern Three/Four Bedroom End of Terrace House**
- **Garage**
- **Off Street Parking for Two Cars**
- **Easy to Maintain Garden**

**Price £585,000**

A superb end of terrace modern house which had been refurbished over the last few years to a high standard. The property has an entrance hall opening onto a large bright reception room; this leads to a large kitchen/dining room with fully fitted kitchen, bifold doors onto an easy to maintain patio garden. In addition there is a double bedroom/playroom on the ground floor with w.c and access to the garage. On the first floor there are two double bedrooms with built in wardrobes, a single bedroom and family bathroom. There is also a garden/storage area to the side and parking for two cars. EPC rating D.









GROUND FLOOR  
665 sq.ft. (61.8 sq.m.) approx.



1ST FLOOR  
401 sq.ft. (37.2 sq.m.) approx.

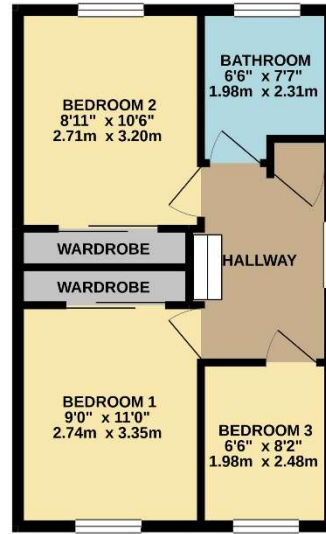

TOTAL FLOOR AREA: 1065 sq.ft. (99.0 sq.m.) approx.

Whilst every attempt has been made to ensure the accuracy of the floorplan contained herein, measurements of doors, windows, rooms and any other items are approximate and no responsibility is taken for any error, omission or mis-statement. This plan is for illustrative purposes only and should be used as such by any prospective purchaser. The services, systems and appliances shown have not been tested and no guarantee as to their operability or efficiency can be given.  
Made with Metropix ©2021