

Cheltenham Close New Malden KT3



- **Two Double Bedrooms**
- **Large Reception Room**
- **Off Street Parking**
- **Private Rear Garden**

Price £1,850 pcm

A newly decorated (in progress) two double bedroom home situated off Elm Road in a residential close within close proximity of Christ Church Schools and Corpus Christi Primary School and within walking distance of New Malden train station. The ground floor comprises a modern fitted kitchen, a good size reception room and a private rear garden and upstairs there is a modern bathroom suite with a fitted heated towel rail and two double bedrooms. There is also off street parking at the front of the property. Available in July and unfurnished. Security deposit £2,134 (based on the asking price. Council tax band D. EPC rating C.



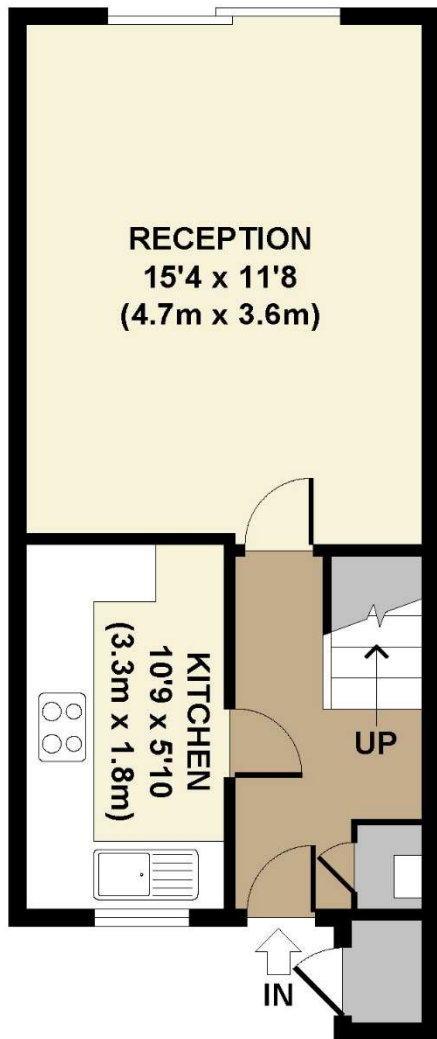

**GROUND FLOOR
GROSS INTERNAL
FLOOR AREA 311 SQ FT**

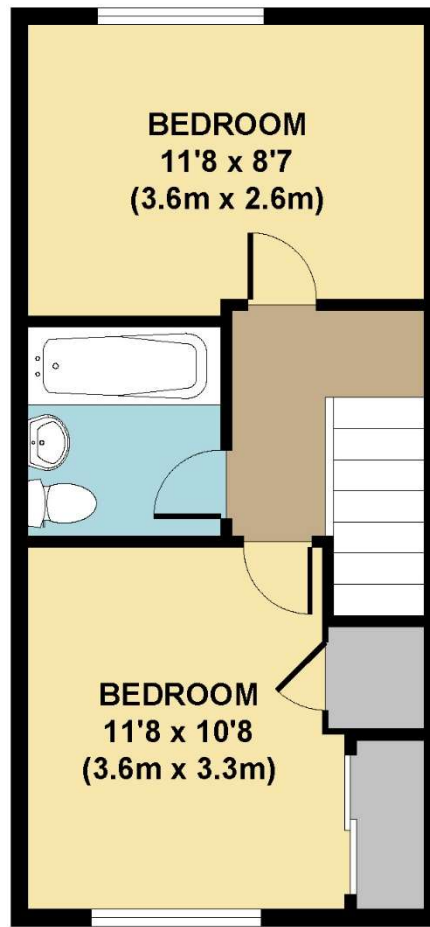

**FIRST FLOOR
GROSS INTERNAL
FLOOR AREA 304 SQ FT**

APPROX. GROSS INTERNAL FLOOR AREA 615 SQ FT / 57 SQ M
 Floorplans are for identification and guideline purposes only, not to scale.
 Compliant with RICS code of measuring practice.



