

Queens Road New Malden KT3



- **Three Bedroom Family Home**
- **Superb Kitchen/Dining Room**
- **Bathroom and En Suite**
- **Large Master Bedroom**
- **West Facing Garden**
- **Close to Burlington School**

Price £3,200 pcm

A stunning family home located on this very popular road within close proximity of many local amenities. Laid out over three floors, the ground floor comprises a ground floor toilet, a through lounge with lots of built-in storage, a superb kitchen/dining room which opens out to a west facing rear garden; the first floor has two bedrooms and a large family bathroom and the top floor has the master bedroom and an en suite shower room. The highly sought after Burlington School is moments away and both the High Street and station are within easy reach. The property is unfurnished and available mid-late September. Security deposit £3,692 (this may vary based on the price agreed). Council tax band E. EPC rating D.

GROUND FLOOR

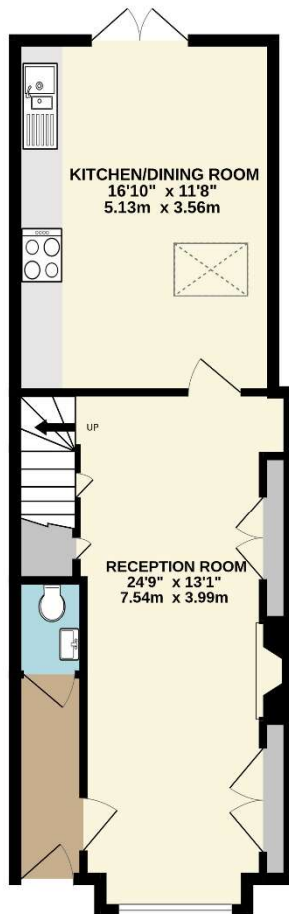

1ST FLOOR

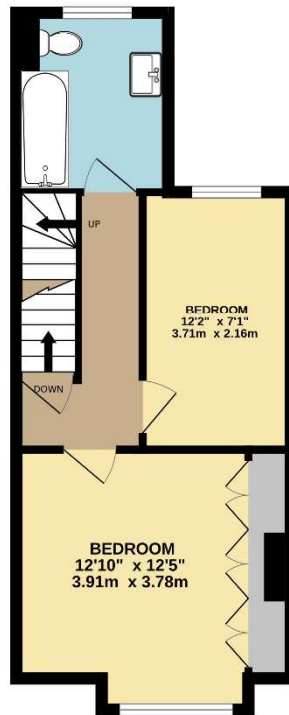

2ND FLOOR



TOTAL FLOOR AREA : 1143 sq.ft. (106.2 sq.m.) approx.

Whilst every attempt has been made to ensure the accuracy of the floorplan contained here, measurements of doors, windows, rooms and any other items are approximate and no responsibility is taken for any error, omission or mis-statement. This plan is for illustrative purposes only and should be used as such by any prospective purchaser. The services, systems and appliances shown have not been tested and no guarantee as to their operability or efficiency can be given.
Made with Metropix ©2023





