

Powdermill Close New Malden KT3



- **Open Plan Reception/Kitchen**
- **Modern Throughout**
- **EPC rating B**
- **Three Bedrooms**
- **Two Bathrooms**
- **Secure Underground Parking**

Price £3,100 pcm

A well presented and very modern three bedroom, two full bathroom split level maisonette located in the popular Kingston East development with secure underground parking. The ground floor of the property has a large entrance hallway, a double bedroom with wardrobes and en-suite bathroom; the first floor has a large open plan kitchen living space which has french doors opening onto the balcony, two further bedrooms and another bathroom plus storage. The parking is located in a secure underground car park and there are private communal gardens. The property is available in July and part-furnished. Council Tax Band C. EPC Rating B. Security Deposit £3,576 (based on the asking price).

GROUND FLOOR

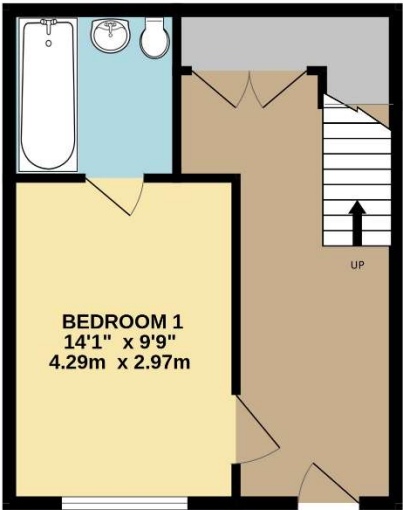

1ST FLOOR

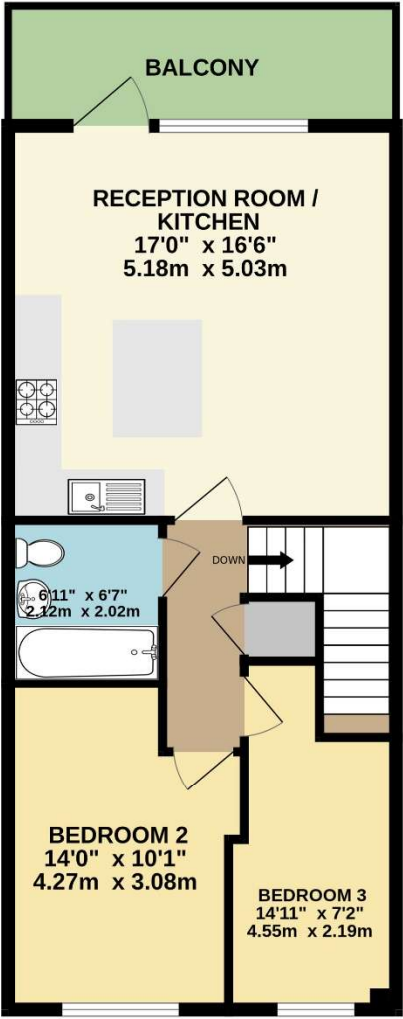

TOTAL FLOOR AREA : 1028sq.ft. (95.5 sq.m.) approx.

Whilst every attempt has been made to ensure the accuracy of the floorplan contained here, measurements of doors, windows, rooms and any other items are approximate and no responsibility is taken for any error, omission or mis-statement. This plan is for illustrative purposes only and should be used as such by any prospective purchaser. The services, systems and appliances shown have not been tested and no guarantee as to their operability or efficiency can be given.
Made with Metropix ©2025