

Chestnut Grove New Malden KT3



- **Stunning Three Double Bedroom Two Bathroom House**
- **Superb Living/Dining/Kitchen**
- **Mature Garden with Studio Room**
- **Master Bedroom with En Suite**
- **Part of "The Groves"**

Price £885,000

A beautifully refurbished period house located in a popular "Groves" location. The property is instantly welcoming with pretty hallway leading into a stunning kitchen/dining/living room. The living area has a bay window and wood burning stove, there is a fully fitted modern kitchen with quartz worktops, a large range oven and plenty of storage and a dining area with brick feature wall and sliding doors leading onto a mature garden laid mainly to lawn with a patio area together with a decking area in front of a spacious studio room with electricity and A.C unit. In addition there is a utility cupboard housing the washing machine and drier and a downstairs W.C, On the top floor is a master bedroom with plenty of storage and an ensuite bathroom. On the first floor there are two further bedrooms and a family bathroom with both and separate walk-in shower. The property is within easy walking distance of New Malden High Street and Station as well as being close to excellent primary and secondary schools. EPC E (from before refurbishment).









GROUND FLOOR
729 sq.ft. (67.7 sq.m.) approx.

1ST FLOOR
400 sq.ft. (37.2 sq.m.) approx.

2ND FLOOR
300 sq.ft. (27.9 sq.m.) approx.

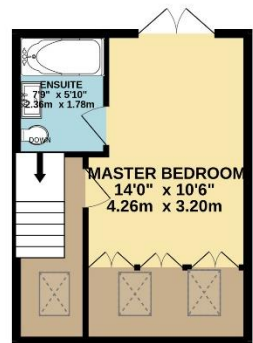
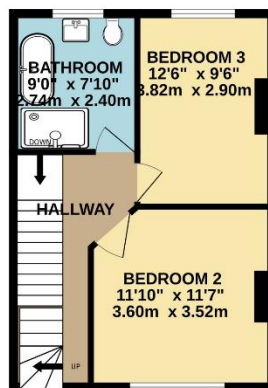

TOTAL FLOOR AREA: 1430 sq.ft. (132.8 sq.m.) approx.

Whilst every attempt has been made to ensure the accuracy of the floorplan contained here, measurements of doors, windows, rooms and any other items are approximate and no responsibility is taken for any error, omission or mis-statement. This plan is for illustrative purposes only and should be used as such by any prospective purchaser. The services, systems and appliances shown have not been tested and no guarantee as to their operability or efficiency can be given.

Made with Metropix ©2023