

Cromwell Avenue New Malden KT3



- **Three Bedrooms**
- **Kitchen/Dining Room**
- **Private Garden**
- **Off-Street Parking**

Price £2,300 pcm

A well-presented family home set in this very popular location within moments of the High Street. The accommodation comprises a front reception room, a dining room which opens into a fitted kitchen, three bedrooms and a family bathroom and there is also a private garden to the rear and off-street parking to the front. There are excellent schools close by as well as very good transport links both in to London and out of town. The property is unfurnished and available mid-August. Security deposit £2,653 (based on the asking price. Council tax band D. EPC rating C.

GROUND FLOOR



1ST FLOOR

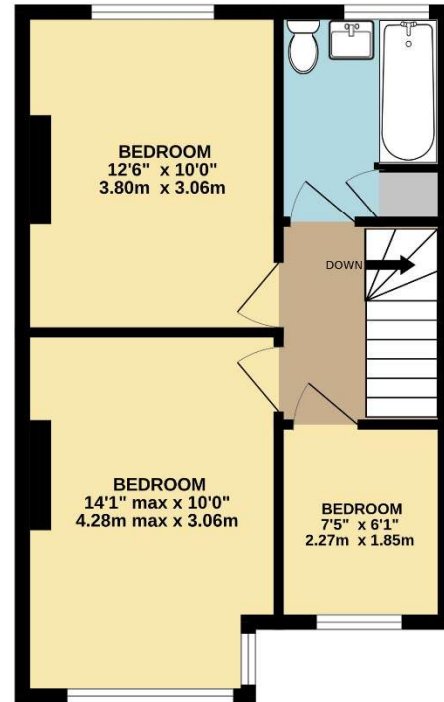

TOTAL FLOOR AREA : 823sq.ft. (76.5 sq.m.) approx.

Whilst every attempt has been made to ensure the accuracy of the floorplan contained here, measurements of doors, windows, rooms and any other items are approximate and no responsibility is taken for any error, omission or mis-statement. This plan is for illustrative purposes only and should be used as such by any prospective purchaser. The services, systems and appliances shown have not been tested and no guarantee as to their operability or efficiency can be given.

Made with Metropix ©2025



