

Nelson Road New Malden KT3



- **Two Double Bedrooms**
- **Large Living Room**
- **Modern Fitted Kitchen**
- **Spacious Throughout**
- **Larger Than Average Private Rear Garden**
- **Available Now**

Price £2,000 pcm

A well presented, modern and tastefully decorated two double bedroom first floor maisonette located within walking distance of New Malden High Street and station. The property comprises a large living room, a modern and stylish fitted kitchen, two double bedrooms, one of which has a large storage cupboard, a white three piece bathroom suit and a larger than average private garden. The property is available now and unfurnished. EPC Rating D. Council Tax Band C. Security Deposit £2,307- based upon an asking price offer.

FIRST FLOOR

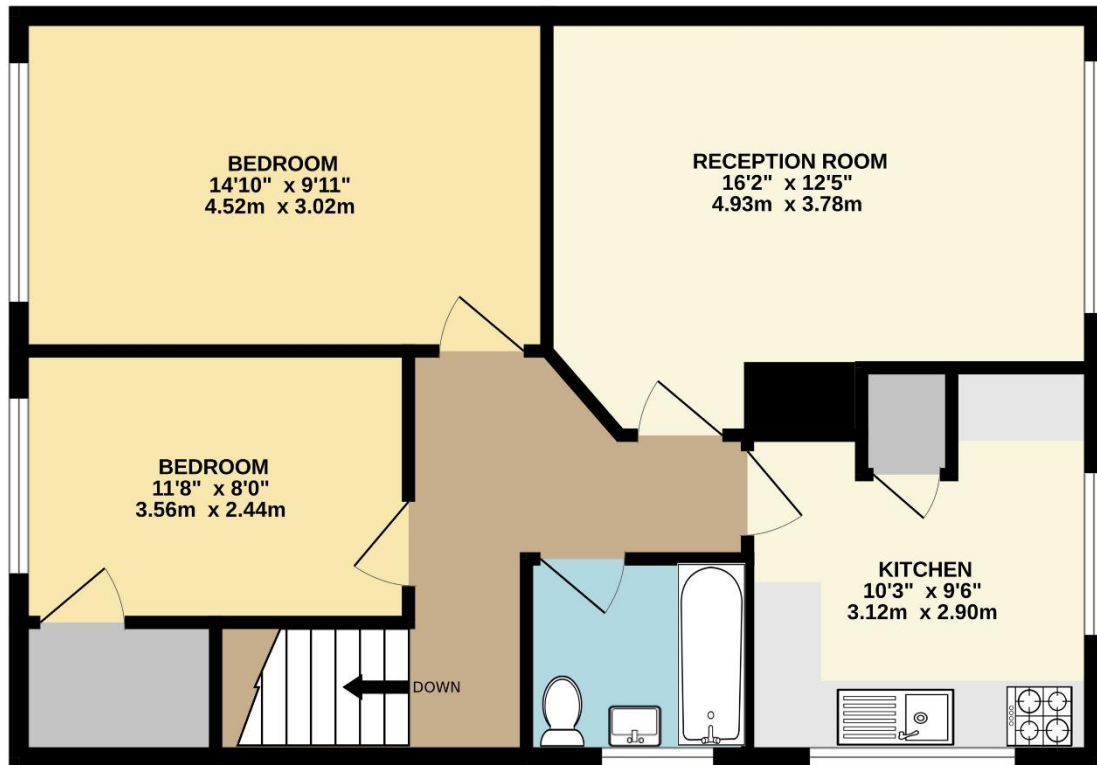

TOTAL FLOOR AREA : 696 sq.ft. (64.7 sq.m.) approx.
Whilst every attempt has been made to ensure the accuracy of the floorplan contained here, measurements of doors, windows, rooms and any other items are approximate and no responsibility is taken for any error, omission or mis-statement. This plan is for illustrative purposes only and should be used as such by any prospective purchaser. The services, systems and appliances shown have not been tested and no guarantee as to their operability or efficiency can be given.
Made with Metropix ©2025





