

## Cambridge Road New Malden KT3



- **Beautiful, Three Bedroom, Victorian, Semi-Detached House**
- **Superb Kitchen/Dining/Living Room**
- **Period Features**
- **Two Bathrooms, GF W.C**
- **South Facing Mature Garden**

**Price £845,000**

Entering this beautiful home, which offers a family-friendly and versatile layout combining a mixture of modern and tradition elements. Your attention is first drawn to its Victorian tiled entrance hall, original fireplaces and thoughtfully extended, well designed, kitchen/dining/living space. There is a vaulted ceiling and bi-fold doors leading out onto a mature south facing garden, with large studio room with electrical power. There is an additional double reception which enhances the overall functionality of the property by providing more living space while giving the opportunity to be adapted the space to suit your lifestyle and family needs. On the first floor there is a master bedroom with en-suite shower room, one double and a large single bedroom together with a family bathroom. The outdoor space helps to make this home a welcoming retreat and whether you are trying to relax and recuperate after a long day at work or hosting friends and family for a social gathering, a breath of fresh air and a burst of natural light provide the perfect complement. New Malden has a welcoming community spirit, a monthly farmers' market, restaurants, local shops, pubs and cafes. EPC rating D, council tax band F.













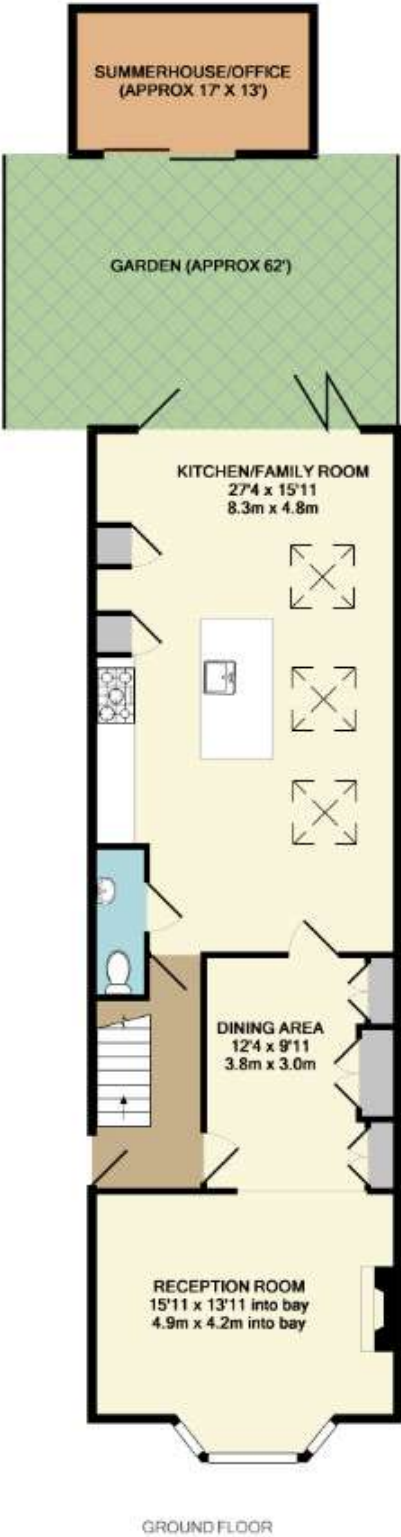

TOTAL APPROX. FLOOR AREA 1440 SQ.FT. (133.8 SQ.M.)

Whilst every attempt has been made to ensure the accuracy of the floor plan contained herein, measurements of doors, windows, rooms and any other items are approximate and no responsibility is taken for any error, omission, or mis-statement. This plan is for illustrative purposes only and should be used as such by any prospective purchaser. The services, systems and appliances shown have not been tested and no guarantee as to their operability or efficiency can be given.

Made with Metropix ©2017

