

Elm Road New Malden KT3



- **Three Bedroom Period House**
- **Popular Groves Location**
- **Two Receptions**
- **Fitted Kitchen**
- **West Facing Rear Garden**
- **Walking Distance to New Malden Station**

Price £650,000

Nestled within the highly coveted 'Groves' area, this pretty three-bedroom Victorian, end-of-terrace home has timeless charm and character. A welcoming front sitting room boasts a classic bay window and a handsome feature fireplace, a second reception room, ideal for a dining room has direct views onto the garden. There is a natural flow from here into the galley style kitchen and bathroom beyond. The garden has a westerly aspect with side access, ideal for relaxing while watching the sun go down. On the first floor two bright, generously proportioned double bedrooms with a further bedroom positioned directly off the rear bedroom, which would be ideal for a nursery or dressing room. Within a leisurely stroll of the 'vibrant' heart of New Malden, the High Street, celebrated for its warm community spirit. Families will also benefit from being in the catchment area for excellent schools. EPC rating D. Council tax band D. No Onward Chain.







GROUND FLOOR

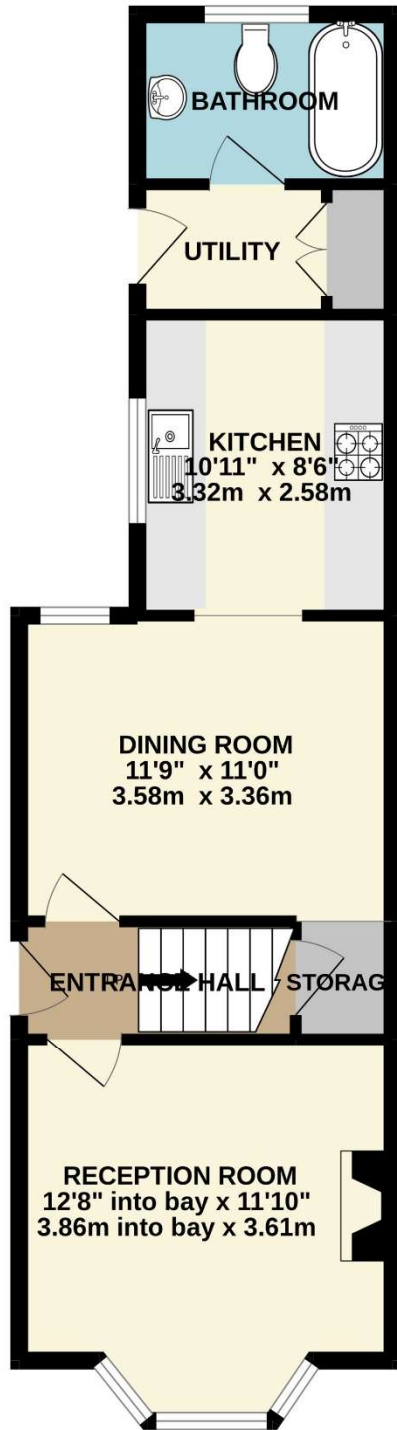

1ST FLOOR

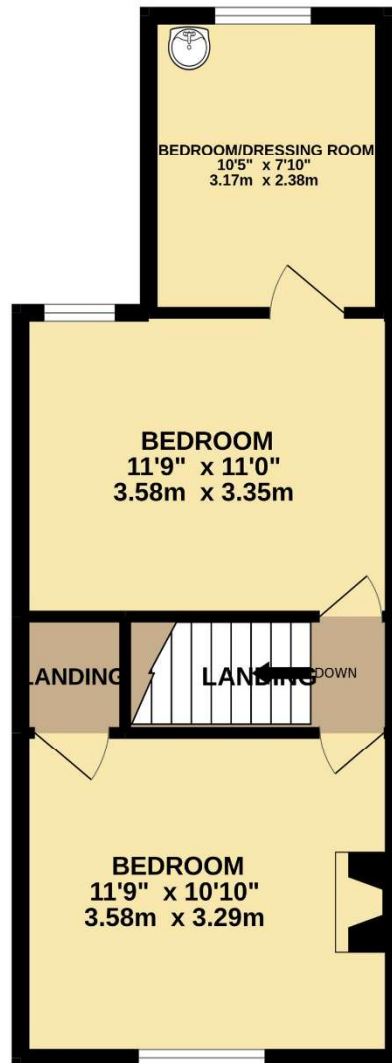

Whilst every attempt has been made to ensure the accuracy of the floorplan contained here, measurements of doors, windows, rooms and any other items are approximate and no responsibility is taken for any error, omission or mis-statement. This plan is for illustrative purposes only and should be used as such by any prospective purchaser. The services, systems and appliances shown have not been tested and no guarantee as to their operability or efficiency can be given.
 Made with Metropix ©2022