

## Egerton Road New Malden KT3



- **Four Bedrooms. Two Bathrooms**
- **Close to Burlington School**
- **Kitchen/Dining Room**
- **Off-Street Parking**

**Price £2,950 pcm**

Located on this very popular road just a short distance from Burlington School, the main High Street and New Malden station, a beautifully presented end of terrace family home offering excellent accommodation throughout. The property comprises two reception rooms, kitchen/breakfast room, ground floor cloakroom, four bedrooms, two bathrooms, off-street parking at the front and a delightful south facing rear garden. Both New Malden High Street and station are within a short walk and Beverley Park is just moments away. The property is unfurnished and available in March. Security deposit £3,403 (based on the asking price). Council tax band E. EPC rating D.





GROUND FLOOR

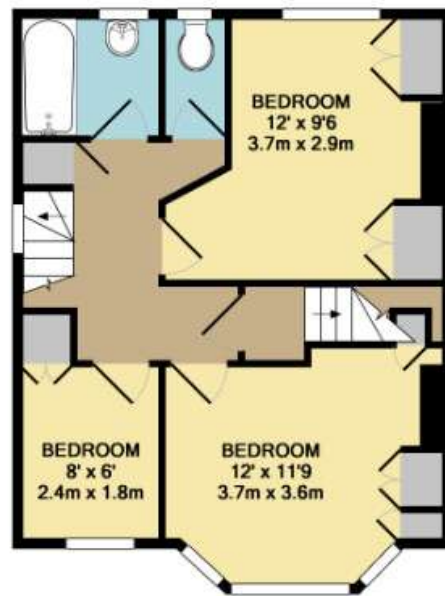

1ST FLOOR

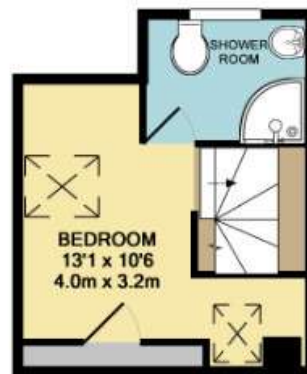

2ND FLOOR

TOTAL APPROX. FLOOR AREA 1352 SQ.FT. (125.6 SQ.M.)

Whilst every attempt has been made to ensure the accuracy of the floor plan contained here, measurements of doors, windows, rooms and any other items are approximate and no responsibility is taken for any error, omission, or mis-statement. This plan is for illustrative purposes only and should be used as such by any prospective purchaser. The services, systems and appliances shown have not been tested and no guarantee as to their operability or efficiency can be given.

Made with Metropix ©2013







