

hillyards.



Scan for further info

- Top floor maisonette
- Two double bedrooms
- No upper chain
- Sought-after location
- Private rear garden
- Extended lease

£235,000 - Leasehold

Ingram Avenue, Aylesbury, Buckinghamshire, HP21 9DN

Ingram Avenue, Aylesbury, Buckinghamshire, HP21 9DN



Approx Gross Internal Area
68 sq m / 626 sq ft

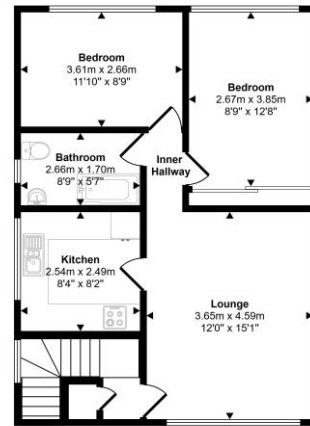

Garden

There is a private garden located to the rear of the property laid mainly to lawn with gated access to parking

Driveway Parking

There is a driveway located to the rear of the property accessed via a rear service road.

Map

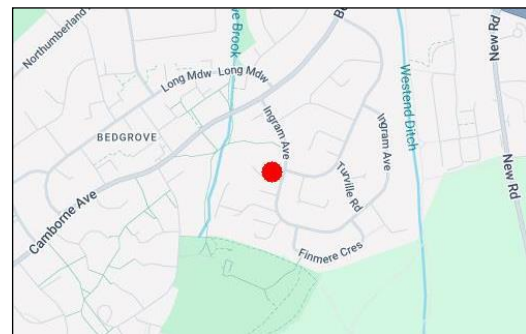

Lease Length

Approximately 125 years remaining.

Ground Rent

£50.00 per year

Council Tax Band

B (approximately £1868.00 per annum based on 2 adults residing at the property).

Energy Performance Graph

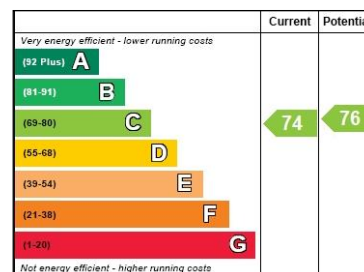

Property Misdescription Act 1991: For clarification, we wish to inform prospective purchasers that we have prepared these sales particulars as a general guide. We have not carried out a detailed survey nor tested the services, appliances and specific fittings. Room sizes should not be relied upon for carpets and furnishings. No person representing HILLYARDS has any authority to make or give any representation or warranty whatever in relation to this property.

The Money Laundering, Terrorist Financing and Transfer of Funds (Information on the Payer) Regulations 2017: Intending purchasers will be asked to produce two forms of identification documents and we would ask for your prompt co-operation in order that there will be no delay in agreeing the sale.

Deposit: Please note that HILLYARDS take and hold a £250.00 deposit from the potential purchaser at the point of an offer being accepted in order for the property to be taken off the market.

Property Details: Awaiting vendors approval. Every care has been taken with the preparation of these particulars but they are for general guidance only and complete accuracy cannot be guaranteed. If there is any point, which is of particular importance please ask, or professional verification should be sought. All dimensions are approximate.

Floor plan: for illustrative purposes only, not to scale.