



Wormald Road, Wallingford, Oxfordshire
£265,000 FREEHOLD

JAMESGESNER
- ESTATE AGENTS -

A one bedroom house terraced situated in this sought after cul-de-sac within easy walking distance of Wallingford town centre and offered for sale with a west facing garden, allocated parking no onward chain.

Situated just under 500 metres on foot from Wallingford town centre and behind the paddocks a short stroll to St Johns Primary School and the town centre. Wallingford has a variety of small shops, pubs and restaurants, the antique shops in the Lamb Arcade, and the parks, commons and gardens make it a very pleasant town. There is a Waitrose Supermarket in the centre and a newly opened Lidl within 400 metres.



19 Wormald Road, Wallingford, Oxfordshire, OX10 9BD

GROUND FLOOR

1ST FLOOR

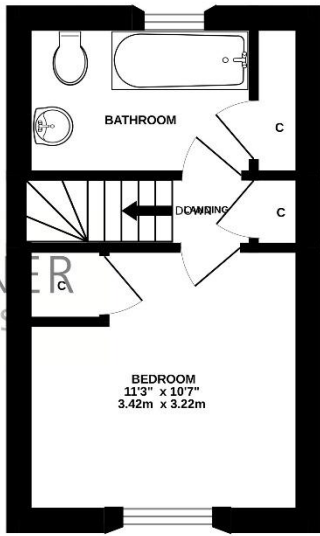
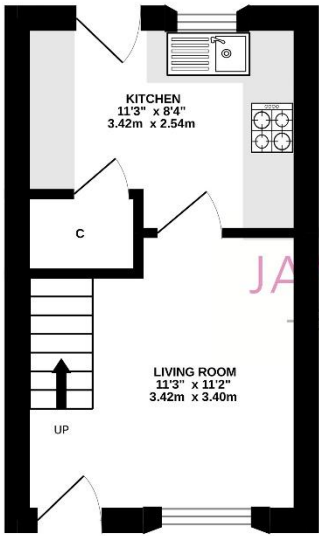
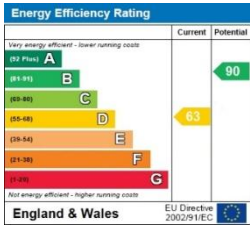

Whilst every attempt has been made to ensure the accuracy of the floorplan contained here, measurements of doors, windows, rooms and any other items are approximate and no responsibility is taken for any error, omission or misstatement. This plan is for illustrative purposes only and should be used as such by any prospective purchaser. The services, systems and appliances shown have not been tested and no guarantee as to their operability or efficiency can be given.
Made with Metreapp ©2023



James Gesner Estate Agents
72 Broadway Didcot, Oxon OX11 8AE
info@jamesgesner.co.uk

t: 01235 519888
t: 01491 522222

Important Notice: These particulars have been prepared for prospective purchasers only. They are not part of an offer or contract. Whilst some descriptions are obviously subjective and information is given in good faith, they should not be relied upon as statements or representations of fact. We have not tested any appliances which may be included in the sale, therefore any purchaser should seek clarification prior to exchange of contracts.