



## Glassmill Lane

Bromley

- Two good Size Bedrooms
- 1st Floor Maisonette
- Lounge/Diner with Park views
- Gas Central Heating
- Integrated Kitchen
- Parking & Small Garden
- Floor Area: 57 sqm (614 sqft)

Price £1,200 pcm



JUST IMAGINE looking out of your window to see the far reaching green spaces of parkland. This delightful 1st floor maisonette is ideally positioned close to Bromley and between two parks with views overlooking Queen`s Mead Recreation grounds.

The property briefly comprises: entrance lobby and stairs to the first floor; lounge/dining room; kitchen/breakfast room; two bedrooms; bathroom with shower over the bath, and a fenced garden with off street parking.

Features include: double-glazed windows; gas central heating, and fitted wardrobes. The kitchen is modern with wall and base units, laminate work surfaces and integrated gas hob and hood; a washing machine, and a fridge/freezer. There is also a shower over the bath and the bathroom does have a window. The property is well presented with light beige fitted carpets.

The property is nicely decorated and well presented with light beige fitted carpets and is situated close to Bromley High Street, within walking distance to Shortlands, Bromley North and Bromley South Railway stations, Sought after schools are also close by, including Valley School and the recently opened Harris Academy. Local shops, parks and sports facilities are also within walking distance from this home. Viewing is highly recommended.

### **Entrance Lobby and Stairs To The First Floor**

### **Lounge/dining room**

### **Kitchen/breakfast room**

### **Master Bedroom**

### **Bedroom Two**

### **Bathroom with shower over the bath**

### **Small fenced garden**

### **Off Street Parking**



# Glassmill Lane, BR2

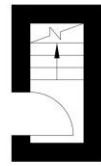
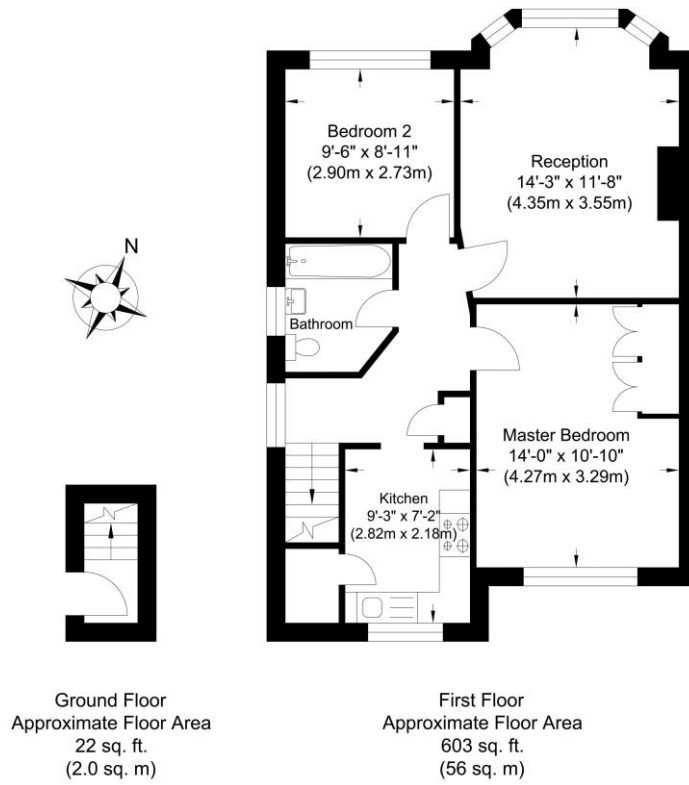

**TOTAL APPROX FLOOR AREA 624 SQ. FT. (AREA 58 SQ. M)**

Whilst every attempt has been made to ensure the accuracy of the floor plan contained here, measurements of doors, windows, rooms and any other items are approximate and no responsibility is taken for any error, omission or mis-statement. This plan is for illustrative purposes only and should be used as such by any prospective purchaser.

