

JOWEBSTER

Blore House, Coleridge Gardens, SW10





Kings Chelsea, SW10 0RB

We are delighted to present this beautifully appointed two-bedroom apartment located within the highly sought-after Kings Chelsea development—a premier gated community in the heart of Chelsea, offering residents a refined and secure lifestyle.

The apartment features a bright and spacious living room, a well-equipped kitchen, a family bathroom, a generous second bedroom, and a master bedroom complete with an en-suite bathroom.

Kings Chelsea is renowned for its exceptional on-site amenities, including a large indoor swimming pool, a fully equipped gym, a tennis court, and immaculately landscaped communal gardens. The development benefits from 24-hour security & concierge services, ensuring complete peace of mind. Ideally positioned between the iconic King's Road and Fulham Road, residents have effortless access to an array of designer boutiques, renowned restaurants, and excellent transport links including rail, bus, and riverboat services—all just a short walk away.

Property Attributes

- Reception Room
- Kitchen
- Two Bedrooms
- Two Bathrooms (One En-Suite)
- Swimming Pool
- Gym
- Tennis Court
- Landscaped Gardens
- 24-hour security

Terms

- £807 per week / £3,500 per month
- Furnished
- Long / Short let (short let subject to a different rental value)
- Royal Borough of Kensington & Chelsea
- No pets
- 5 weeks security deposit

+44 (0)20 7349 7055

lettings@jowebster.com

www.jowebster.com

Important Notice

These sales particulars are believed to be correct, but their accuracy is not guaranteed, nor do they form any part of a contract. We have not carried out a detailed survey nor tested services, appliances or fittings. Purchasers must satisfy themselves by inspection or otherwise.

BLORE HOUSE, SW10

Approximate gross internal area = 809 sq ft / 75.14 sq m

Key:
CH - Ceiling Height

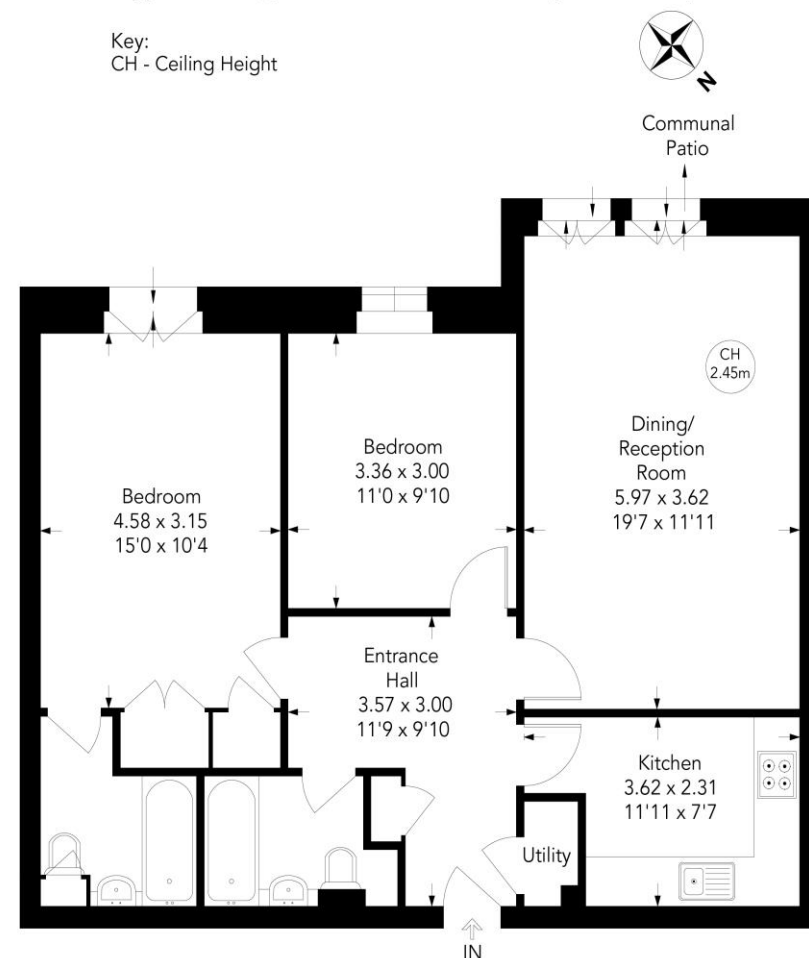

Ground Floor

Not to scale, for guidance only and must not be relied upon as a statement of fact.
All measurements and areas are approximate only