

Onslow Gardens,
South Kensington, SW7

JOWEBSTER





88 Onslow Gardens, South Kensington, SW7

An extremely bright and well proportioned 1 bedroom apartment on the third floor of this white stucco fronted period building in this sought after location in the heart of South Kensington. It is located in the quietist part of Onslow Gardens with no through traffic and facing towards Ensor Mews.

The west facing reception room benefits from two large sash windows, feature marble fire place and built in shelving/storage unit, there is a separate eat in west facing kitchen. The spacious bedroom benefits from garden views and has a dressing room and en-suite bathroom. There is key to use the communal gardens behind the property.

Onslow Gardens is ideally located close to a good range of shops, restaurants & bars on the Old Brompton Road and South Kensington Underground Station is a short walk away.

Property Attributes

- One Bedroom
- Reception Room
- Kitchen
- Dressing Room
- En-suite Bathroom
- Communal Gardens

Terms

- Royal Borough of Kensington & Chelsea

Onslow Gardens,
South Kensington, SW7 3BS

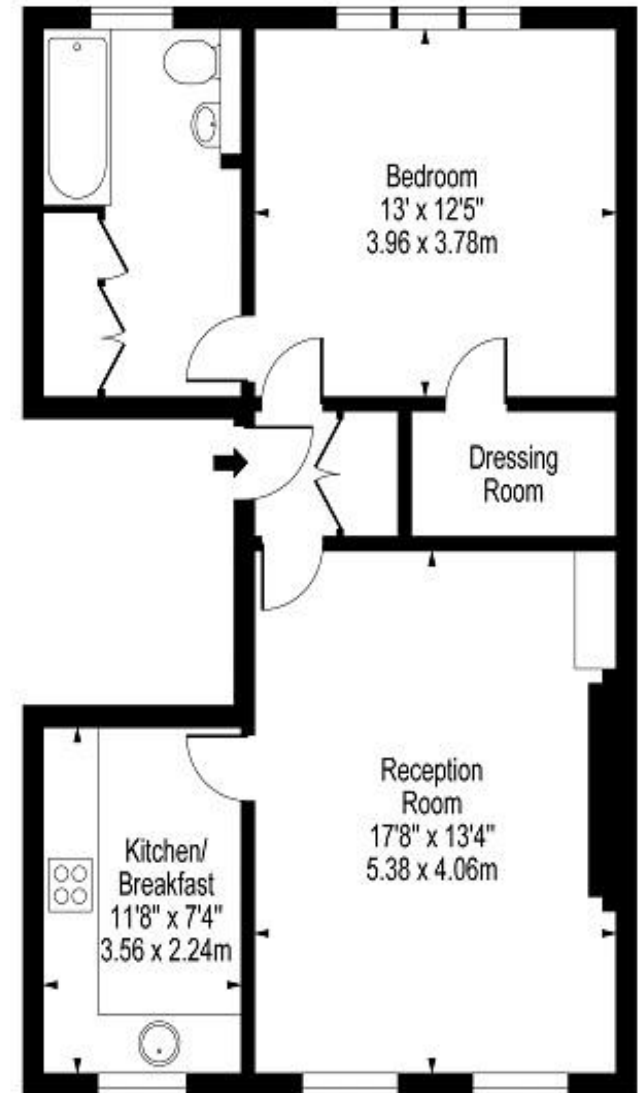

Third Floor

Approx Gross Internal Area **658 Sq Ft - 61.13 Sq M**

For Illustration Purposes Only - Not To Scale
Floor Plan by www.bpmmediagroup.com
Ref: No. E31685

+44 (0)20 7349 7055
sales@jowebster.com
www.jowebster.com

Important Notice

These sales particulars are believed to be correct, but their accuracy is not guaranteed, nor do they form any part of a contract. We have not carried out a detailed survey nor tested services, appliances or fittings. Purchasers must satisfy themselves by inspection or otherwise.