

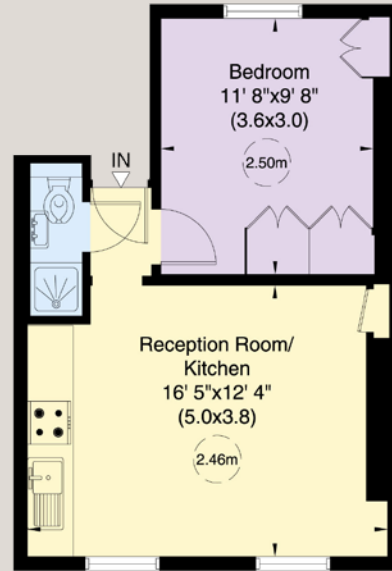

Disraeli Road, SW15



Approx. Gross Internal Area
360 sq ft (33 sq m)



Second Floor



Disraeli Road, SW15

A compact one bedroom apartment on the second floor of a Victorian building close to Putney High Street. An open plan reception room/kitchen is at the front of the building, with a bedroom and shower-room to the rear. The apartment is ideal as a pied a terre with excellent transport links nearby, and easy access into and out of London.

Terms

Tenure Leasehold, a new 999 year lease to be granted

Local Authority London Borough of Wandsworth

EPC E

Council Tax Band D

Listing Not Listed

Conservation Area No

Parking On street permit parking

Price £325,000 Subject to Contract

For clarification purposes we wish to inform all interested parties that we have prepared these particulars as a general guide. We have not carried out a detailed survey nor tested the services, appliances and specific fittings. Room sizes should not be relied upon for carpets and furnishings

JOHN WILCOX
& Co.

020 7602 2352

www.johnwilcox.co.uk