

## BALLS POND ROAD N1

TOTAL APPROX FLOOR PLAN AREA INCLUDING RESTRICTED HEAD HEIGHT AND EAVES STORAGES 856 SQ.FT (80 SQ.M)

TOTAL APPROX FLOOR PLAN AREA EXCLUDING RESTRICTED HEAD HEIGHT AND EAVES STORAGES 845 SQ.FT (78 SQ.M)

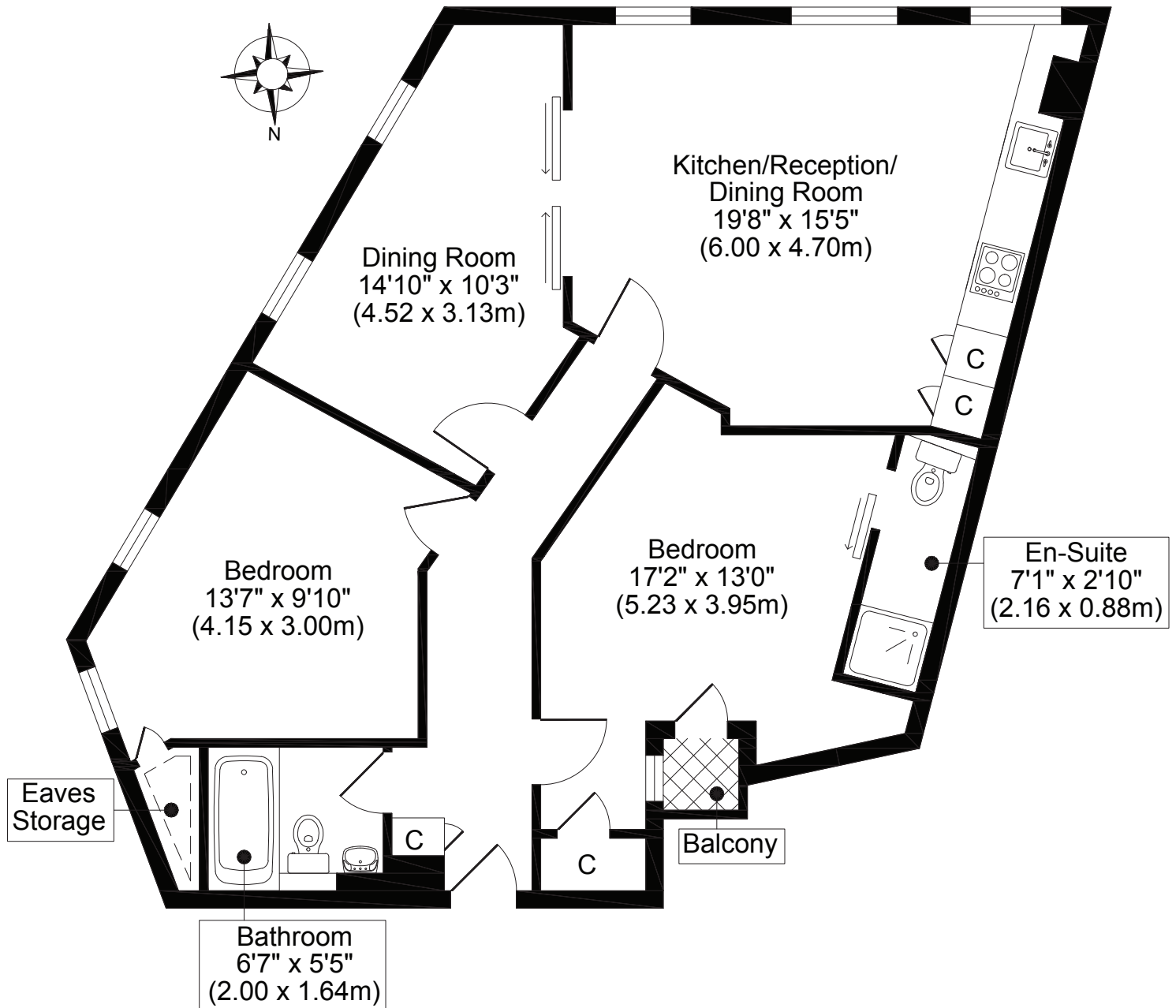

THIRD FLOOR