

FLAT 14, 546 CHISWICK HIGH RD W4 5RG

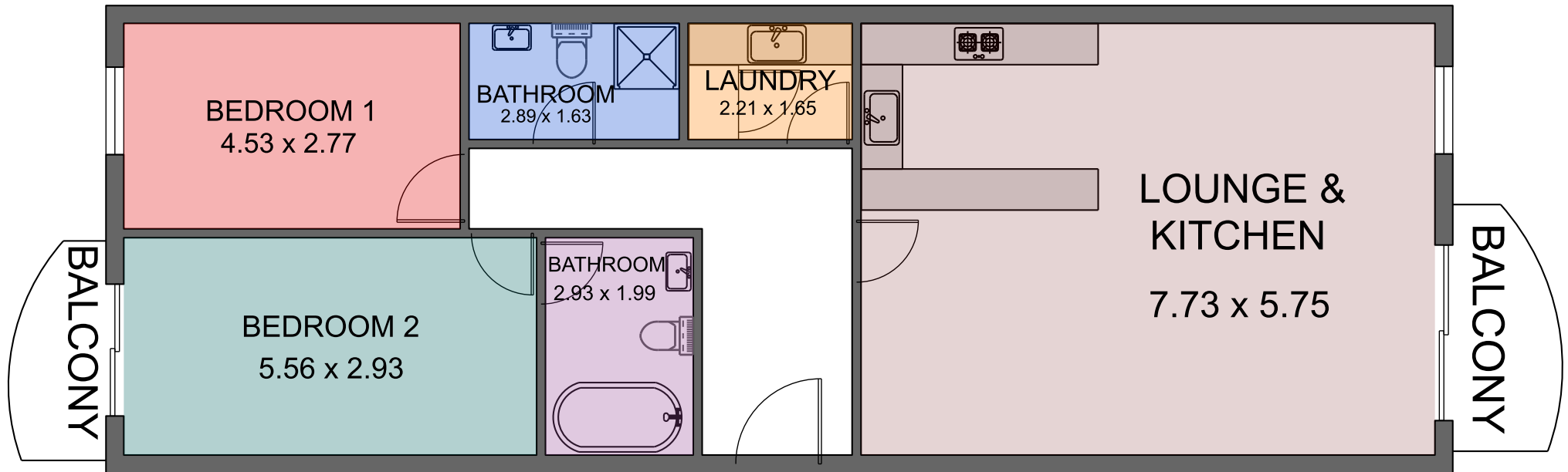

TOTAL AREA: 87.55 SQM (EXCL. BALCONIES)

***Please Note. Whilst every attempt has been made to ensure that these floor plans are accurate, please note that measurements are approximate and no responsibility is taken for any error, omission or misstatement. These plans are not drawn to scale and are for identification purposes only and should be used as such by interested parties. No guarantee is given for total square area. Figures given are for initial guidance only and should not be relied upon for valuation purposes or form part of any agreement. ***