



The Rye

Eaton Bray

- Brand New Barn Conversion
- Available Now!
- Open plan living
- Bespoke handmade oak kitchen units
- Parking for two cars
- Landscaped rear garden

Price £475,000 Subject To Contract



Layco Properties proudly presents this brand new barn conversion, situated in Eaton Bray and converted to a high standard boasting open plan living. The home is ready to move into so an early viewing is highly recommended...

The property enters into an open plan living room/kitchen with plenty of natural light including double doors to the rear garden. The living area is spacious and the kitchen is fitted with bespoke handmade oak units.

There are two generous bedrooms, with the main bedroom also boasting double doors out to the front. The bathroom is fitted with a suite comprising; WC, hand basin and bath with shower above.

Outside there is off road parking for two cars and to the rear, a good sized rear garden that also includes a patio area.

Agents note: the soil has recently been seeded so external photos have been edited.

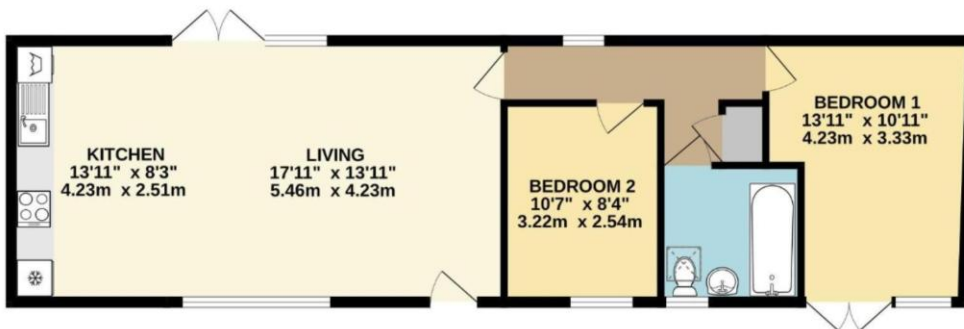

24 Parton Road, Aylesbury, Buckinghamshire, HP20 1NG
Tel: 01296 791960 / 01525 307600 | Email: Sales@laycoproperties.co.uk
<https://www.laycoproperties.co.uk>

