



Eastham Rake, Eastham

£180,000



LESLEY HOOKS
ESTATE AGENTS





This delightful three-bedroom semi-detached home offers a welcoming blend of character and comfort, with a lovely cottage-style ambiance throughout.

Step through the front door into a bright entrance hall, leading to a cosy lounge complete with a charming fireplace, perfect for relaxing evenings. At the rear of the property, you'll find a spacious open-plan kitchen/diner—ideal for family meals and entertaining—featuring a door to the rear garden and another giving access to the ground floor bathroom.

Upstairs, the first floor boasts three well-proportioned bedrooms, each filled with natural light and offering flexibility for family living, guest accommodation, or a home office.

Outside, the property enjoys a lovely front garden with an array of shrubs and trees, while the rear garden provides a private and peaceful retreat with plenty of space for outdoor enjoyment. Additional benefits include a driveway offering ample off-road parking and a garage for storage or further potential.

Combining traditional charm with practical living spaces, this property is a wonderful place to call home.



Entrance Hall

4'5" (1.35m) x 4'3" (1.3m)

Lounge

15'2" (4.62m) x 13'11" (4.24m)

Dining Room

11'2" (3.4m) x 6'9" (2.06m)

Kitchen

16'4" (4.98m) x 11'11" (3.63m)

Bedroom One

17'8" (5.38m) x 8'3" (2.51m)

Bedroom Two

10'11" (3.33m) x 9'8" (2.95m)

Bedroom Three

7'10" (2.39m) x 7'6" (2.29m)

Bathroom

8'0" (2.44m) x 5'8" (1.73m)

Garage

17'9" (5.41m) x 7'10" (2.39m)







GROUND FLOOR
683 sq.ft. (63.4 sq.m.) approx.

1ST FLOOR
310 sq.ft. (28.8 sq.m.) approx.

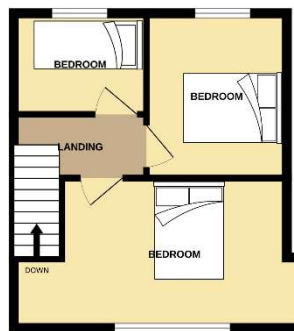

TOTAL FLOOR AREA: 993 sq.ft. (92.3 sq.m.) approx.

Whilst every attempt has been made to ensure the accuracy of the floorplan contained here, measurements of doors, windows, rooms and any other items are approximate and no responsibility is taken for any error, omission or mis-statement. This plan is for illustrative purposes only and should be used as such by any prospective purchaser. The services, systems and appliances shown have not been tested and no guarantee as to their operability or efficiency can be given.
Made with Metreps 62925

Disclaimer: Whilst these details are thought to be correct, their accuracy cannot be guaranteed and do not form part of any contract. It should be noted that we have not tested any fixtures, fittings, equipment, apparatus or services, therefore we cannot verify that they are in working order of fit for purpose. Solicitors should be used to confirm that any moveable items described within these details are in fact part of the sale agreement. While we try to ensure measurements are correct they are not guaranteed and purchasers are advised to take their own measurements before ordering any fixtures and fittings. Please note: if you are buying a leasehold property, please ensure that all details and conditions of the lease are checked with your solicitor prior to you incurring any costs as additional fees could be incurred for items such as leasehold packs.