



Westminster Drive, Bromborough

£230,000



LESLEY HOOKS
ESTATE AGENTS





This Dutch style semi detached is ready to put your own stamp on. Having uPVC double glazing and gas central heating the layout comprises entrance hallway, dining room, lounge and kitchen and downstairs WC. Upstairs there are three bedrooms and a shower room with separate wc. Outside the property there is a driveway with off road parking leading to the rear where you will find a southerly facing garden mostly laid to lawn with patio seating area and mature shrub borders. Ideally situated within walking distance of three popular local primary schools including Raeburn, Mendell and Christ the King with local amenities straight to hand. Bromborough train station is also a walk away and Bromborough retail park a short drive away with its vast array of stores, restaurants and leisure pursuits. No Chain. Council tax band C



Hall

13'8" (4.17m) x 6'6" (1.98m)

Lounge

14'0" (4.27m) x 13'4" (4.06m)

Dining Room

13'3" (4.04m) x 9'4" (2.84m)

Downstairs WC

4'6" (1.37m) x 3'0" (0.91m)

Kitchen

9'5" (2.87m) x 7'7" (2.31m)

Conservatory

10'3" (3.12m) x 6'3" (1.91m)

Bedroom One

14'0" (4.27m) x 10'5" (3.18m)

Bedroom Two

10'4" (3.15m) Max x 9'9" (2.97m) Max
Narrowing to 6'0" and 9'9"

Bedroom Three

11'9" (3.58m) x 9'4" (2.84m)

Bathroom

8'5" (2.57m) x 6'3" (1.91m)

Separate WC

5'11" (1.8m) x 2'11" (0.89m)







GROUND FLOOR

1ST FLOOR

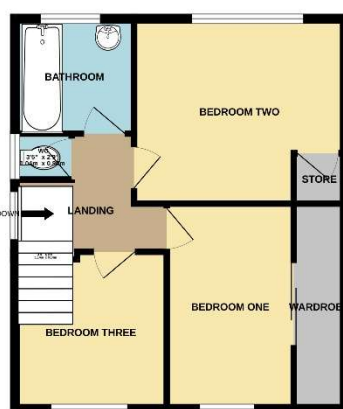

contact Us:

1 334 5875

ay@lesleyhooks.co.uk

Alport Lane, Bromborough,
Merseyside, CH62 7HH

Whilst every attempt has been made to ensure the accuracy of the floorplan contained herein, measurements of doors, windows, rooms and any other items are approximate and no responsibility is taken for any errors, omissions or misstatements. This plan is for illustrative purposes only and should be used as such by any prospective purchaser. The services, fixtures and appliances shown have not been tested and no guarantee as to their operability or efficiency can be given.
Made with Metrepro ©2025.

Disclaimer: Whilst these details are thought to be correct, their accuracy cannot be guaranteed and do not form part of any contract. It should be noted that we have not tested any fixtures, fittings, equipment, apparatus or services, therefore we cannot verify that they are in working order of fit for purpose. Solicitors should be used to confirm that any moveable items described within these details are in fact part of the sale agreement. While we try to ensure measurements are correct they are not guaranteed and purchasers are advised to take their own measurements before ordering any fixtures and fittings. Please note: if you are buying a leasehold property, please ensure that all details and conditions of the lease are checked with your solicitor prior to you incurring any costs as additional fees could be incurred for items such as leasehold packs.