



Linkside, Bebington

£279,995



LESLEY HOOKS
ESTATE AGENTS





This semi-detached house is situated in a highly coveted location, offering both privacy and convenience. Upon entry, you are greeted by a spacious hallway leading to a convenient WC. The property boasts two well-proportioned reception rooms, perfect for entertaining guests or simply relaxing with family. The kitchen dining room is the heart of the home, with ample space for cooking and dining. Upstairs, there are three generously sized bedrooms, all with natural light flooding in. The four-piece bathroom is modern and stylish, providing a luxurious space to unwind after a long day. The property also benefits from a garage and driveway, providing ample parking for multiple vehicles. The generous rear garden is perfect for enjoying the outdoors, with plenty of space for children to play or for hosting summer barbecues. This property truly offers a wonderful opportunity to live in a highly sought-after location, with all the amenities you could need right on your doorstep. Overall, this type of property combines traditional charm with modern living conveniences. Council tax band B. Freehold.



Hallway

16'5" (5m) x 6'11" (2.11m)

Porch entrance, wood flooring, built in storage cupboard, stained glass window to the side.

WC

3'8" (1.12m) x 2'10" (0.86m)

WC and wash hand basin, window to the side.

Lounge

13'2" (4.01m) Into Bay x 12'1" (3.68m)

Wood flooring, fireplace with gas fire, bay window to the front.

Sitting Room

15'4" (4.67m) x 12'4" (3.76m)

Wood flooring, fireplace with open fire, door out to the garden.

Kitchen Dining Room

20'0" (6.1m) x 9'1" (2.77m) Max

Fitted kitchen with excellent range of units in beech at both eye and floor level, oven, four ring gas hob, cooker hood, space and plumbing for appliances, windows to the rear and sides, door to the rear, ceiling down lights.



Bedroom One

13'1" (3.99m) Into Bay x 12'3" (3.73m)

Built in cupboard, bay window to the front.

Bedroom Two

12'6" (3.81m) x 12'5" (3.78m)

Window to the rear.

Bedroom Three

7'10" (2.39m) x 7'2" (2.18m)

Window to the front.

Bathroom

10'3" (3.12m) x 7'3" (2.21m)

Stylish bathroom with four piece suite in white comprising bath, shower cubicle, wash hand basin and wc, stained glass windows to the rear and side, storage cupboard, ceiling down lights.





GROUND FLOOR

1ST FLOOR

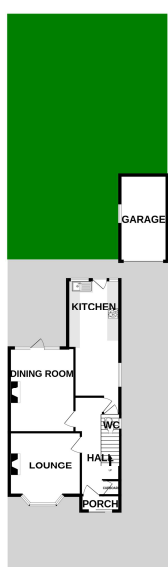

Contact Us:

0151 644 6000

lesley@lesleyhooks.co.uk

6 Church Road, Bebington,

Wirral, Merseyside, CH63 7PH

While every effort has been made to ensure the accuracy of the floorplans contained here, measurements of doors, windows, rooms and any other items are approximate and no responsibility is taken for any errors, omissions or misstatements. The plans are for illustrative purposes only and should be used as such by any prospective purchaser. The services, systems and appliances shown have not been tested and no guarantee is given for their operation or condition.

Made with Hoxbyplan 12.0.02

Disclaimer: Whilst these details are thought to be correct, their accuracy cannot be guaranteed and do not form part of any contract. It should be noted that we have not tested any fixtures, fittings, equipment, apparatus or services, therefore we cannot verify that they are in working order of fit for purpose. Solicitors should be used to confirm that any moveable items described within these details are in fact part of the sale agreement. While we try to ensure measurements are correct they are not guaranteed and purchasers are advised to take their own measurements before ordering any fixtures and fittings. Please note: if you are buying a leasehold property, please ensure that all details and conditions of the lease are checked with your solicitor prior to you incurring any costs as additional fees could be incurred for items such as leasehold packs.