



Brome Way, Spital

£325,000



LESLEY HOOKS
ESTATE AGENTS





Welcome to this absolutely immaculate link-detached home, offering stylish and contemporary living with a high specification throughout. From the moment you step inside, you'll appreciate the attention to detail, with elegant oak doors, sleek Karndean flooring on the ground floor, and the comfort of uPVC double glazing and combi-fired gas central heating. The well-designed layout begins with a welcoming hallway, leading to a handy downstairs WC and a bright, inviting lounge. The smartly fitted kitchen boasts luxurious granite worktops and flows seamlessly into the dining room, where double doors open to the beautiful rear garden. A separate utility room provides additional convenience, with direct access to the garage. Upstairs, you'll find three well-proportioned bedrooms, each designed for comfort, along with a stunning, fully tiled modern shower room. The exterior is just as impressive, with a generous driveway providing off-road parking for several cars and access to the garage. To the rear, the most divine garden awaits—an idyllic outdoor retreat with a patio area, all enjoying a desirable south-westerly aspect. Ideally situated, this home is within walking distance of excellent local primary, secondary, and grammar schools, making it perfect for families. Move-in ready and beautifully presented, this is a property you won't want to miss! Council tax band D. Freehold.



Hallway

16'9" (5.11m) x 5'9" (1.75m)

Downstairs WC

5'0" (1.52m) x 4'7" (1.4m)

Lounge

13'4" (4.06m) x 12'9" (3.89m)

Kitchen

10'11" (3.33m) x 8'10" (2.69m)

Dining Room

10'3" (3.12m) x 8'9" (2.67m)

Utility Room

11'1" (3.38m) x 7'4" (2.24m)

Bedroom One

13'1" (3.99m) x 9'9" (2.97m)

Bedroom Two

12'5" (3.78m) x 8'8" (2.64m)

Bedroom Three

9'3" (2.82m) x 7'0" (2.13m)

Bathroom

7'7" (2.31m) x 5'6" (1.68m)

Garage

16'0" (4.88m) x 8'8" (2.64m)







GROUND FLOOR

1ST FLOOR

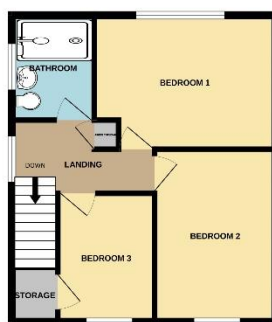

Whilst every attempt has been made to ensure the accuracy of the floorplan contained here, measurements of rooms, windows, doors and any other items are approximate and no responsibility is taken for any error, omission or mis-statement. This plan is for illustrative purposes only and should be used as such by any prospective purchaser. The symbols, systems and appliances shown have not been tested and no guarantee is made in their operation or efficiency due to age.

Made with Metreplan 12/2015

Contact Us:

0151 644 6000

lesley@lesleyhooks.co.uk

6 Church Road, Bebington,

Wirral, Merseyside, CH63 7PH

Disclaimer: Whilst these details are thought to be correct, their accuracy cannot be guaranteed and do not form part of any contract. It should be noted that we have not tested any fixtures, fittings, equipment, apparatus or services, therefore we cannot verify that they are in working order of fit for purpose. Solicitors should be used to confirm that any moveable items described within these details are in fact part of the sale agreement. While we try to ensure measurements are correct they are not guaranteed and purchasers are advised to take their own measurements before ordering any fixtures and fittings. Please note: if you are buying a leasehold property, please ensure that all details and conditions of the lease are checked with your solicitor prior to you incurring any costs as additional fees could be incurred for items such as leasehold packs.