

Ground Floor

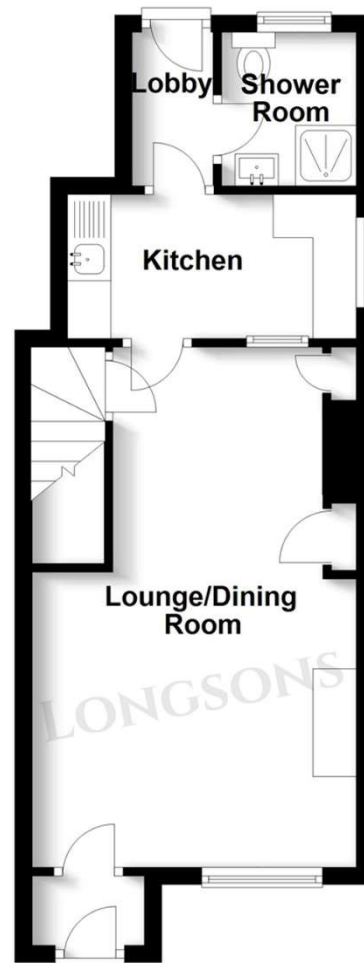

First Floor

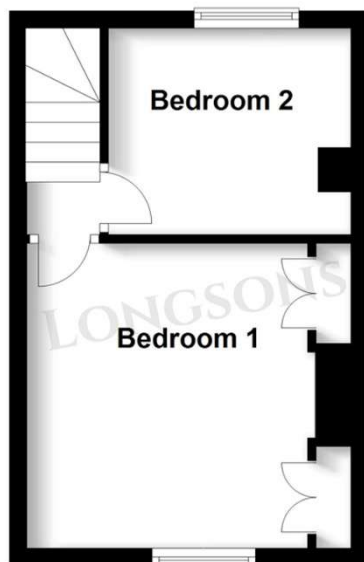

**Lynn Road, Swaffham, PE37 7BB**

CHAIN FREE! Mid terrace, two bedroom period property situated within easy reach of Swaffham town centre. The property offers modern electric radiators and UPVC double glazing. Viewing highly recommended!

**Price £129,950 Freehold**







Please note we have not tested any apparatus, fixtures, fittings, or services. Interested parties must undertake their own investigation into the working order of these items. All measurements are approximate and photographs provided for guidance only.

- CHAIN FREE
- Easy Reach of Town Centre
- Two Bedrooms
- Modern Electric Radiators
- UPVC Double Glazing
- Lounge/Dining Room

Situated within easy reach of the Norfolk market town Swaffham, Longsons are delighted to bring to the market this mid terraced two bedroom period property. The property offers modern electric radiators and UPVC double glazing.

Offered for sale CHAIN FREE!

Viewing highly recommended.

Briefly, the property offers entrance porch, lounge/dining room, kitchen, rear lobby, ground floor shower room, two bedrooms, front garden, modern electric radiators and UPVC double glazing.

#### Entrance Porch

UPVC double glazed entrance door to front, UPVC double glazed window to side, tiles to floor.

#### Lounge/Dining Room

**19'9" (6.02m) Max x 12'4" (3.76m) Max**

Feature fireplace (not in use) with tiles to hearth and wooden mantle over, built in understairs storage cupboard, built in

storage and shelving units, UPVC double glazed window to front, two modern electric radiators, wall mounted air conditioning unit, door opening to stairs to first floor.

#### Kitchen

#### **11'0" (3.35m) x 5'6" (1.68m) Irregular Shape**

Fitted kitchen units to wall and floor, worksurface over, stainless steel sink unit with drainer, space for electric oven, space and plumbing for washing machine, tiled splashback, obscure glass UPVC double glazed window to side.

#### Rear Lobby

UPVC double glazed entrance door opening to rear, UPVC double glazed window to side, electric radiator.

#### Shower Room

Shower cubicle, wash basin, WC, electric radiator, tiled splashback, obscure glass UPVC double glazed window to rear.

#### Stairs and Landing

#### Bedroom 1

#### **11'7" (3.53m) x 10'3" (3.12m) To Wardrobe**

Built in wardrobe, built in cupboard housing hot water cylinder, UPVC double glazed window to front, loft access, modern electric radiator.

#### Bedroom 2

#### **9'7" (2.92m) x 8'0" (2.44m)**

Built in over stairs storage cupboard, UPVC double glazed window to rear, modern electric radiator.

#### Outside Front

Small low maintenance front garden laid to concrete, path to front door, Pickett fence to perimeter.

#### Rear Garden

Small area with garden wall to perimeter and space for wheelie bin storage, gated access to rear.

