

The Carson

3 Bedroom Semi-detached

Plots 201, 202, 246, 247, 259, 260, 263, 264, 267, 268

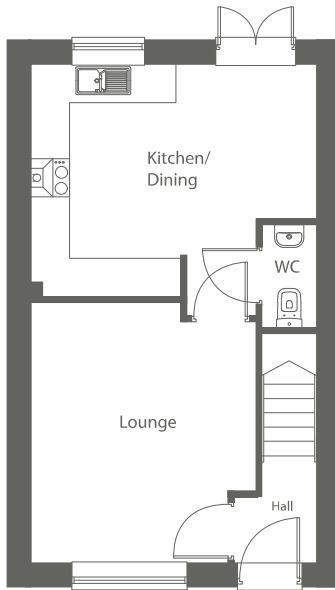

Ground Floor

Kitchen / Dining	4448 x 3633	14'5" x 11'10" †
Lounge	3507 x 4064	11'5" x 13'2" †
W.C	855 x 1610	2'9" x 5'3"

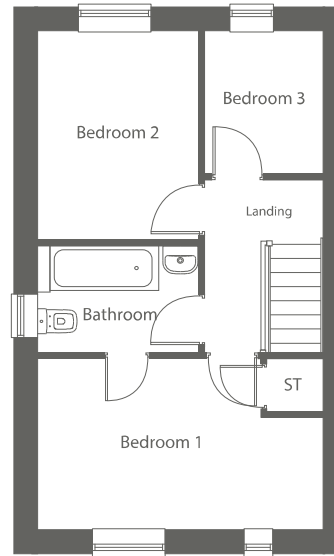

First Floor

Bedroom 1	4449 x 2676	14'5" x 8'8" †
Bedroom 2	2513 x 3262	8'2" x 10'7"
Bedroom 3	1848 x 2227	6'0" x 7'3"
Bathroom	2513 x 1671	8'2" x 5'5"

Please note: The floors plans and dimension on this leaflet applies to plots Plots 201, 202, 246, 247, 259, 260, 263, 264, 267, 268

Site Plan Reference

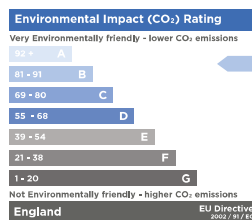
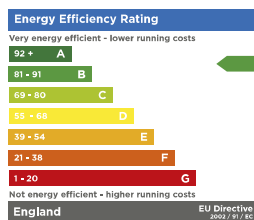

www.woodlands-cheshire.co.uk

† Denotes longest measurement taken. These measurements should not be used for the purchase of carpets and curtains. All dimensions are + or - 50mm and floor plans are not shown to scale. Artist's impressions are used for illustration purposes only. Elevations, external treatments, brick, roof tile colour, window positions, landscaping and garden fencing may vary. The energy rating graph is typical of this property type. Each individual property has its own graph which we will either supply on request or as part of our reservation documentation. Please see our Sales Advisor for full specification and plot details at this development.
Emedia-Woodlands-Cheshire. Revision Date: 06.04.23

**CONSUMER
CODE FOR
HOME BUILDERS**

www.consumercode.co.uk