



Westmoreland House, Forfar Drive, Bletchley, MK3 7LU

Price £180,000 Leasehold



Offered for sale with no above chain is this first floor two bedroom flat situated in West Bletchley. The property offers great size accommodation, with a kitchen, lounge with a door to the balcony, two double bedrooms and a bathroom.



Forfar Drive

Bletchley, MK3 7LU

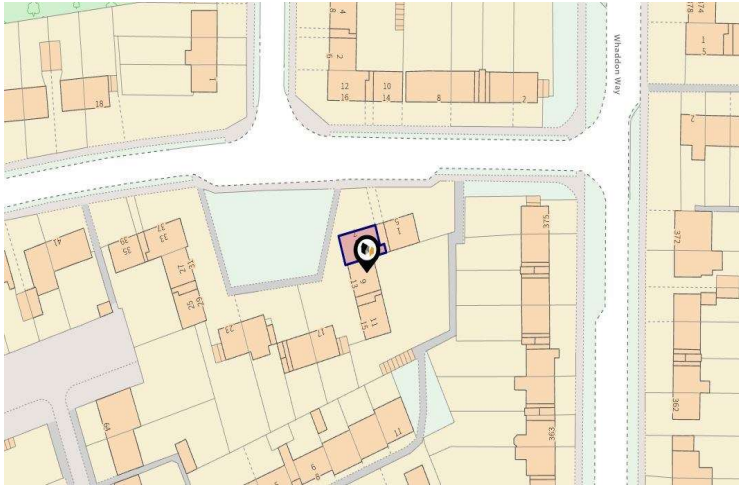

The vendor has informed the agent of:

Annual Service Charge: £230 (includes building insurance)

Annual Ground Rent: £10

Years Of Lease Remaining: 104

Council Tax Band A



Forfar Drive is situated in the popular residential area of West Bletchley with a range of local amenities to include shops, healthcare facilities and schooling from primary to secondary. West Bletchley is served by major roads the A4 Watling Street and A421 providing road access to the A5, M1, Central Bletchley with a High Street, leisure centre, mainline train station and bus terminal, Central Milton Keynes with a large shopping centre, mainline train station and a wide range of leisure facilities. Also, the historic Bletchley Park is nearby as well as green spaces and parks.

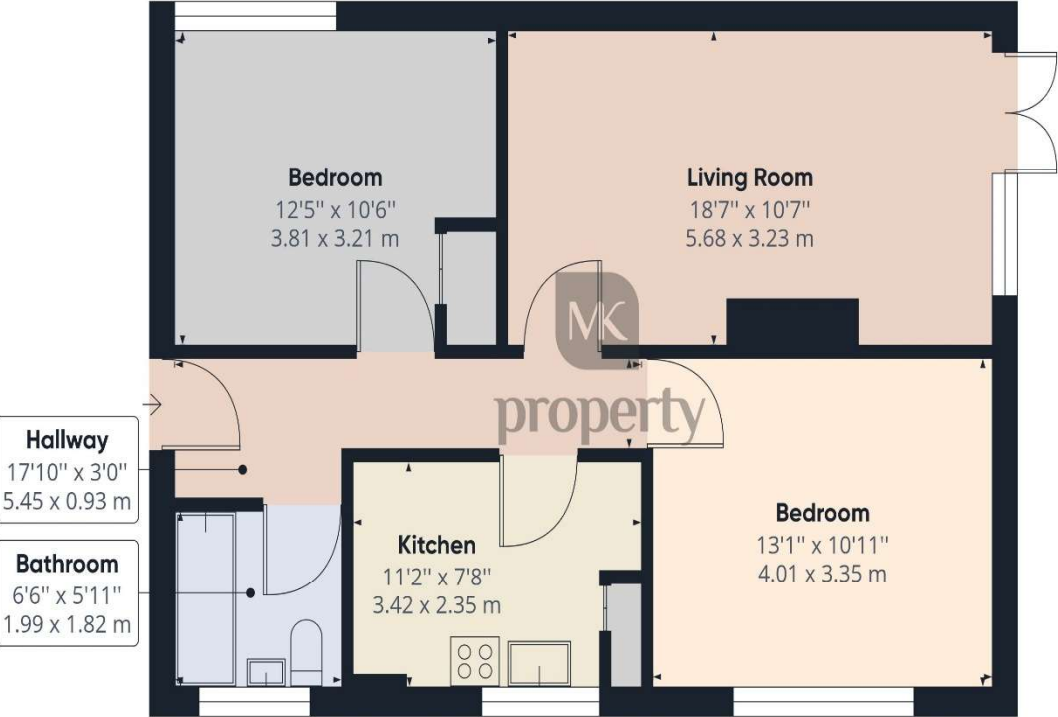

Approximate total area⁽¹⁾
656.24 ft²
60.97 m²

(1) Excluding balconies and terraces

While every attempt has been made to ensure accuracy, all measurements are approximate, not to scale. This floor plan is for illustrative purposes only.

GIRAFFE360



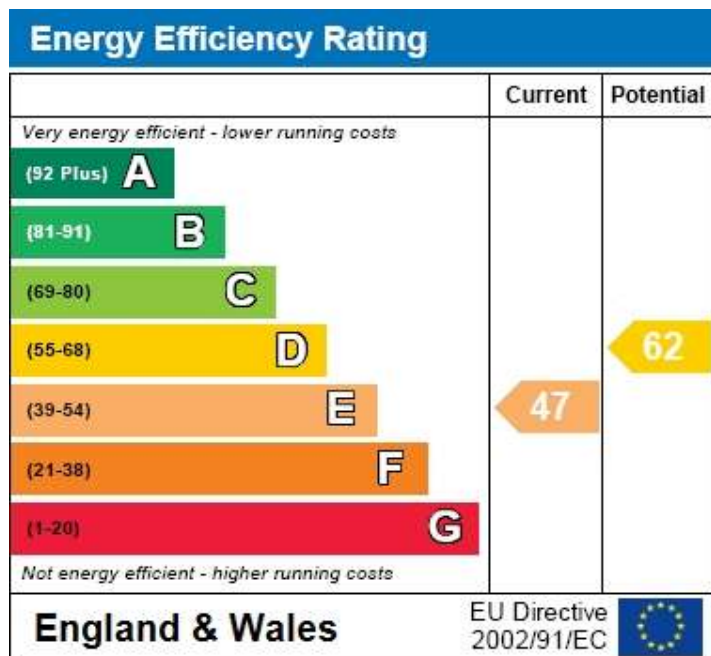

Notice

Please note we have not tested any apparatus, fixtures, fittings, or services. Interested parties must undertake their own investigation into the working order of these items. All measurements are approximate and photographs provided for guidance only.



The Old Manse
73 High Street
Newport Pagnell
MK16 8AB

T: 01908 373580
E: sales@mkproperty.org

