



Offers Over £100,000

Located on in the popular residential area of Lakeside Drive with stunning water and countryside views is this delightful one double bedroom first floor maisonette. Offering accommodation comprising entrance hallway, landing, lounge views, modern fitted kitchen with views, one double bedroom with window overlooking the gardens and a modern fitted bathroom. Outside is an enclosed rear garden mostly laid to grass with mature shrubbery and a pathway to the far end. There is an outside storage shed and a front garden which is landscaped and laid to lawn with a number of flower beds to the borders. The property would make a great first home or buy to let investment.

Lakeside Drive, Ernesettle, PL5 2QJ

Accommodation Comprises

Entrance

Private front door to entrance hall, stairs rising to first floor landing

Landing

Lounge 4.09m (13` 5") x 3.63m (11` 11")

Kitchen 2.87m (9` 5") x 2.29m (7` 6")

Bedroom 3.12m (10` 3") x 2.00m (6` 7")

Bathroom

Outside

The property benefits from a front garden and pathway leading to a rear garden mainly laid to lawn with one storage shed.

Other Information

Lease Length remaining -

Service Charge -

Ground Rent -

Viewing Arrangements

Viewing strictly by appointment through the agent. Please respect the occupier's privacy and do not make an approach by knocking on the door.





Ground Floor

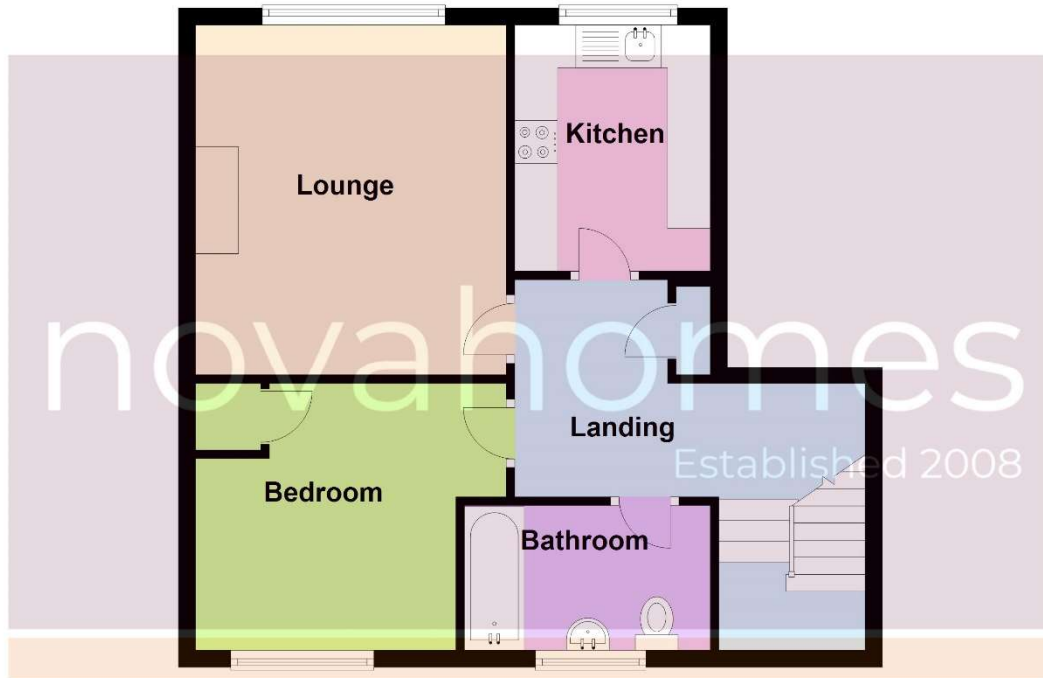

Whilst every attempt has been made to ensure the accuracy of the floor plan contained here, measurements of doors, windows, rooms and any other items are approximate and no responsibility is taken for any error, omission or mis-statement. This plan is for illustrative purposes only and should be used as such by any prospective purchaser. The services, systems and appliances shown have not been tested and no guarantee as to their operability or efficiency can be given.
Plan produced using PlanUp.

Notice: Please note we have not tested any apparatus, fixtures, fittings, or services. Interested parties must undertake their own investigation into the working order of these items. All measurements are approximate and photographs provided for guidance only.

