



Asking Price £315,000

Novahomes are delighted to present this stunning three-bedroom end-terrace home, offering modern and stylish living in the sought-after Sherford development. Thoughtfully designed and well-maintained, this property provides a spacious and inviting atmosphere, perfect for families or professionals alike. Being an end-terrace, the home benefits from additional windows to the side elevation, allowing plenty of natural light to flow throughout the property, enhancing its bright and airy feel. The ground floor boasts a high-spec fitted kitchen and dining area, a spacious lounge ideal for relaxation, and a convenient downstairs WC. Upstairs, you'll find three well-proportioned bedrooms, including a master suite with an en-suite shower room, alongside a contemporary family bathroom. Externally, the home features both front and rear gardens, providing excellent outdoor space, as well as a garage and off-street parking for added convenience. Combining modern comfort with practicality, this exceptional home is a fantastic opportunity—schedule a viewing today!

novahomes

Established 2008

 01752 206040

 sales@novahomes.co.uk

 www.novahomes.co.uk

Perseus Crescent, Sherford, PL9 8GX

Accommodation Comprises

Ground Floor

Entrance Hall

Kitchen/Diner 3.43m (11`3") x 2.55m (8`4")

WC 1.88m (6`2") x 1.03m (3`5")

Lounge 4.71m (15`5") x 3.68m (12`1") plus 8.37m (27`6") x 8.37m (27`6")

First Floor

Landing

Bedroom 1 3.39m (11`1") x 1.80m (5`11")

En-suite 1.76m (5`9") x 1.65m (5`5")

Bedroom 2 3.28m (10`9") x 2.60m (8`7")

Bedroom 3 3.68m (12`1") max x 2.01m (6`7")

Bathroom 2.02m (6`7") x 1.70m (5`7")

Garage 6m (19`8) x 3m (9`10")

Viewing Arrangements

Viewing strictly by appointment through the agent. Please respect the occupier's privacy and do not make an approach by knocking on the door.







Ground Floor

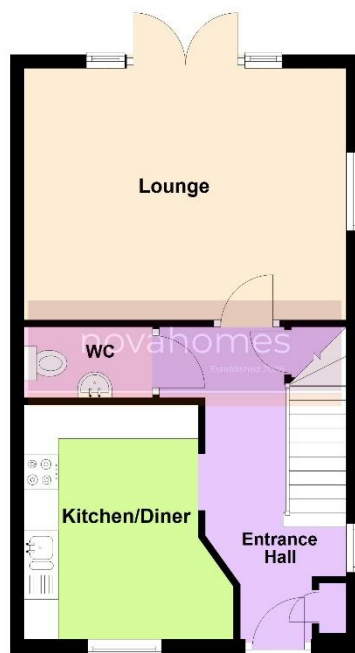

First Floor



Energy Efficiency Rating	
Current	Potential
A	96
B	84
C	
D	
E	
F	
G	

Notice: Please note we have not tested any apparatus, fixtures, fittings, or services. Interested parties must undertake their own investigation into the working order of these items. All measurements are approximate and photographs provided for guidance only.

